



Welcome to St. Patrick Hospital

500 W. Broadway
Missoula, MT 59802
406.329.5650
www.saintpatrick.org

Welcome to St. Patrick Hospital.

We are committed to providing you with compassionate, high quality medical care. If you have questions or concerns anytime during your visit, please ask any member of our staff for assistance. We welcome the opportunity to be of service to you.

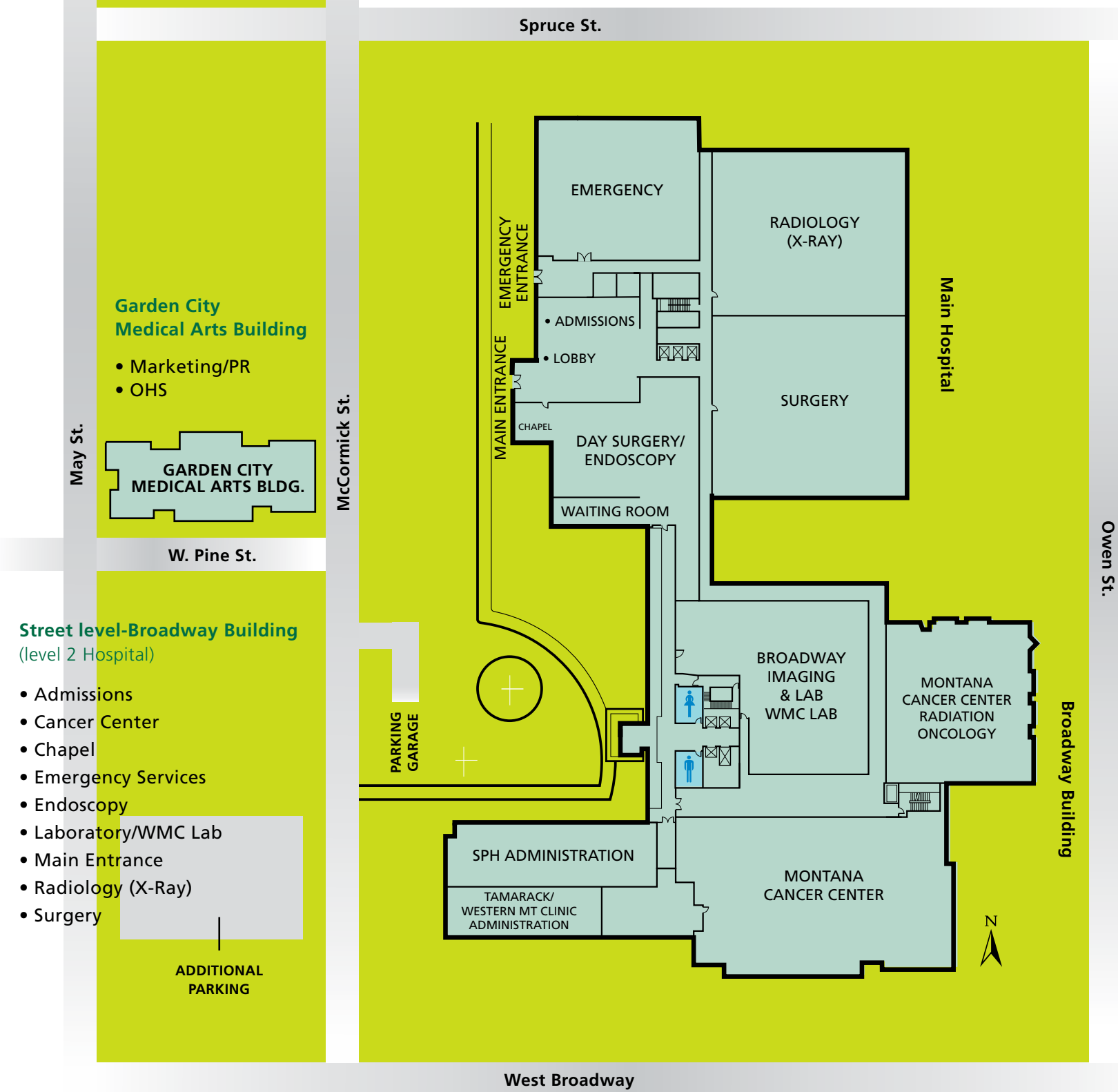
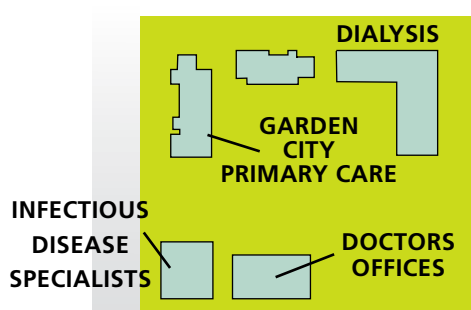

St. Patrick Facilities Tobacco Free Areas

Printed on recycled paper using recyclable inks

Tobacco Free Zones

- St. Patrick Building
- Tobacco Free Area

- A St. Patrick Hospital
- B Parking Lot
- C North Building
- D South Buildings
- E Parking Lots
- F 600 W. Building
- G Garden City Medical Plaza
- H Dialysis
- I Laundry
- J Providence Center
- K St. Patrick House
- L Parking Lot



Level 5

- Bariatric Surgery
- Trauma Services
- Western Montana Clinic**
- Audiology /
- Dermatology
- Gastroenterology
- Speech Therapy
- Missoula Surgical Assoc.**

BROADWAY BUILDING LEVEL 5



BROADWAY BUILDING LEVEL 6

- Level 6**
- Western Montana Clinic**
 - Dietitian
 - Endocrinology
 - Family Practice
 - Orthopedic Surgery
 - Rheumatology

BROADWAY BUILDING LEVEL 4

- Level 4**
- Western Montana Clinic**
 - Allergy
 - Internal Medicine
 - Nephrology
 - Pulmonology
 - Sleep Medicine

MAIN HOSPITAL LEVEL 5

5 NORTH MEDICAL RENAL ONCOLOGY (ROOMS 530-559)

INFUSION CENTER

SLEEP CENTER

5 SOUTH SURGERY / PEDIATRICS INFUSION CENTER SLEEP CENTER

MAIN HOSPITAL LEVEL 4

4 NORTH CARDIOVASCULAR RESIRATORY (Rooms 430-459)

4 SOUTH ORTHOPEDIC NEUROSURGERY NEUROLOGY (Rooms 400-429)

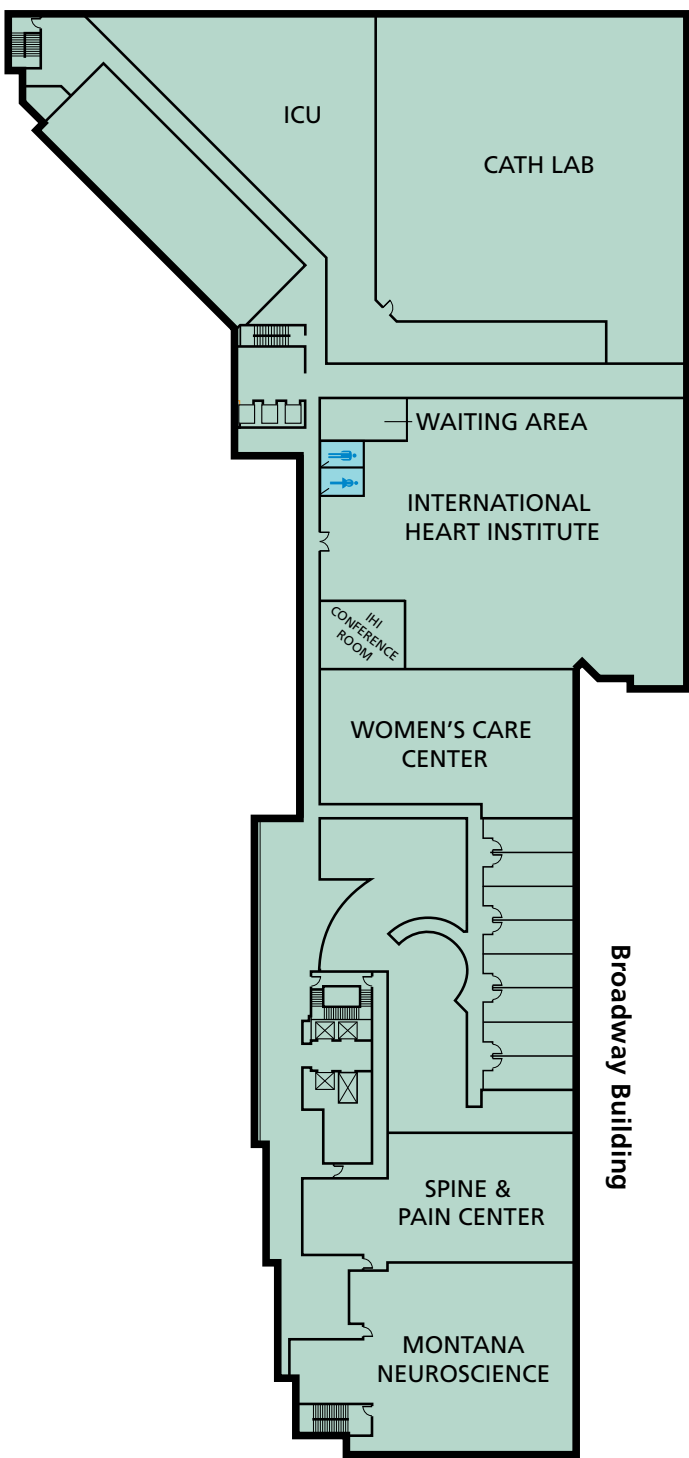

Level 3

- Cath Lab
- ICU
- IHI Conference Room
- International Heart Institute
- Montana Neuroscience
- Spine & Pain Center
- Women's Care Center
- Neurological Associates**

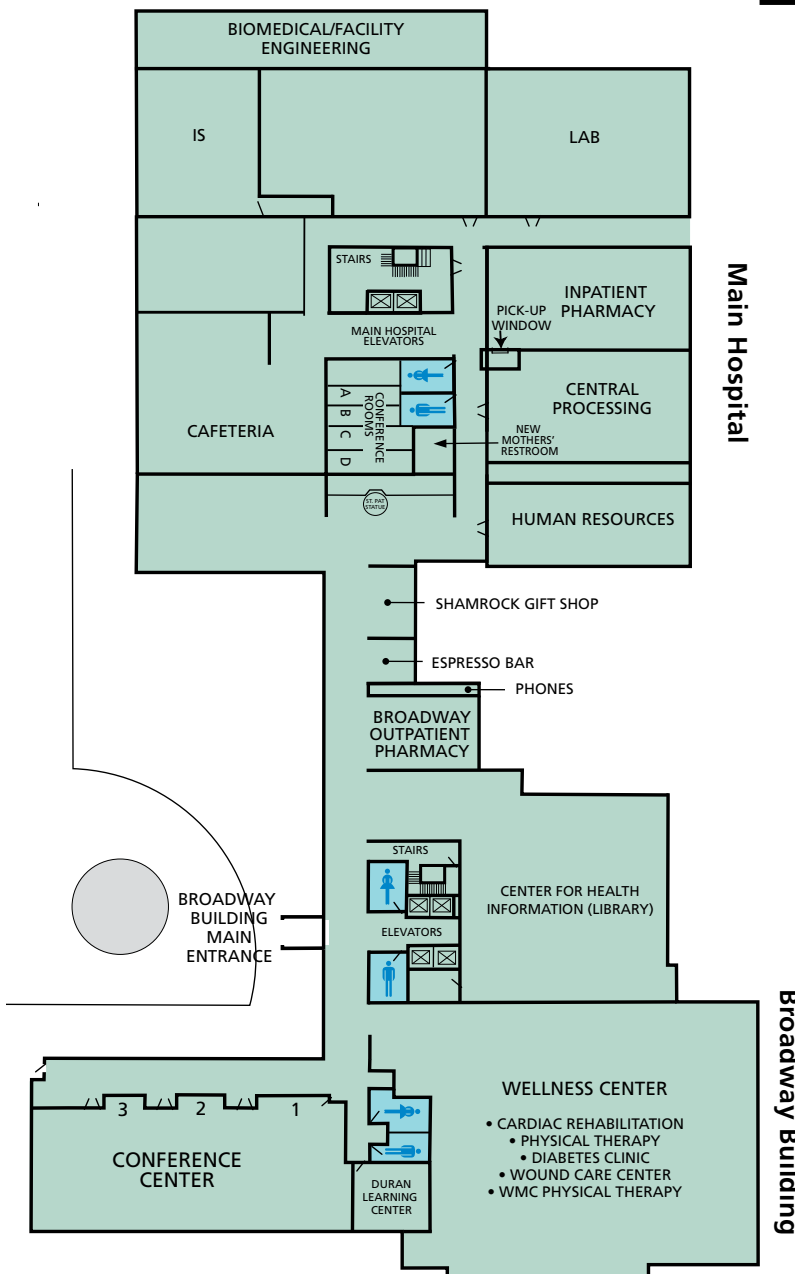

Level 1

- Biomedical Engineering
- Broadway Pharmacy
- Cafeteria
- Center for Health Information
- Central Processing
- Conference Center
- Conference Rooms
- Espresso Bar
- Human Resources

- Gift Shop
- Information Services
- Inpatient Pharmacy
- Laboratory
- Wellness Center/Rehab Services
- WMC Physical Therapy**

Level 2 (see other side)

Providence Center

902 N. Orange
Missoula, MT 59802

- L1 • Adolescent Partial Hospitalization Program
- Cafeteria
- Community Benefit
- Medication Assistance
- Mission Leadership
- Surgery Center
- L2 • Providence Surgery Center
- L3 • Neurobehavioral Inpatient Unit
- L4 • Inpatient Rehab

Medical Plaza

- First Step
- Providence Psychiatry
- St. Patrick Hospital and Health Foundation

