



CONSTRUCTION PLANS FOR:

DUNCAN DRIVE TRAILHEAD PROJECT

DJ&A PROJECT # 7603

CITY OF MISSOULA, MONTANA



LOCATION MAP

| INDEX TO SHEETS | |
|-----------------|-------------------------|
| NO. | DESCRIPTION |
| 1 | COVER |
| 2 | GENERAL NOTES & LEGEND |
| 3 | ABBREVIATIONS |
| 4 | PROJECT QUANTITIES |
| 5 | DEMOLITION PLAN |
| 6 | SITE PLAN OVERVIEW |
| 7 | GRADING PLAN |
| 8 | POINT TABLE |
| 9 | SIGNAGE & STRIPING PLAN |
| 10 | GENERAL CIVIL DETAILS |
| 11 | DETAILS |
| 12 | VEHICLE TRACKING |

APPROVED FOR CONSTRUCTION

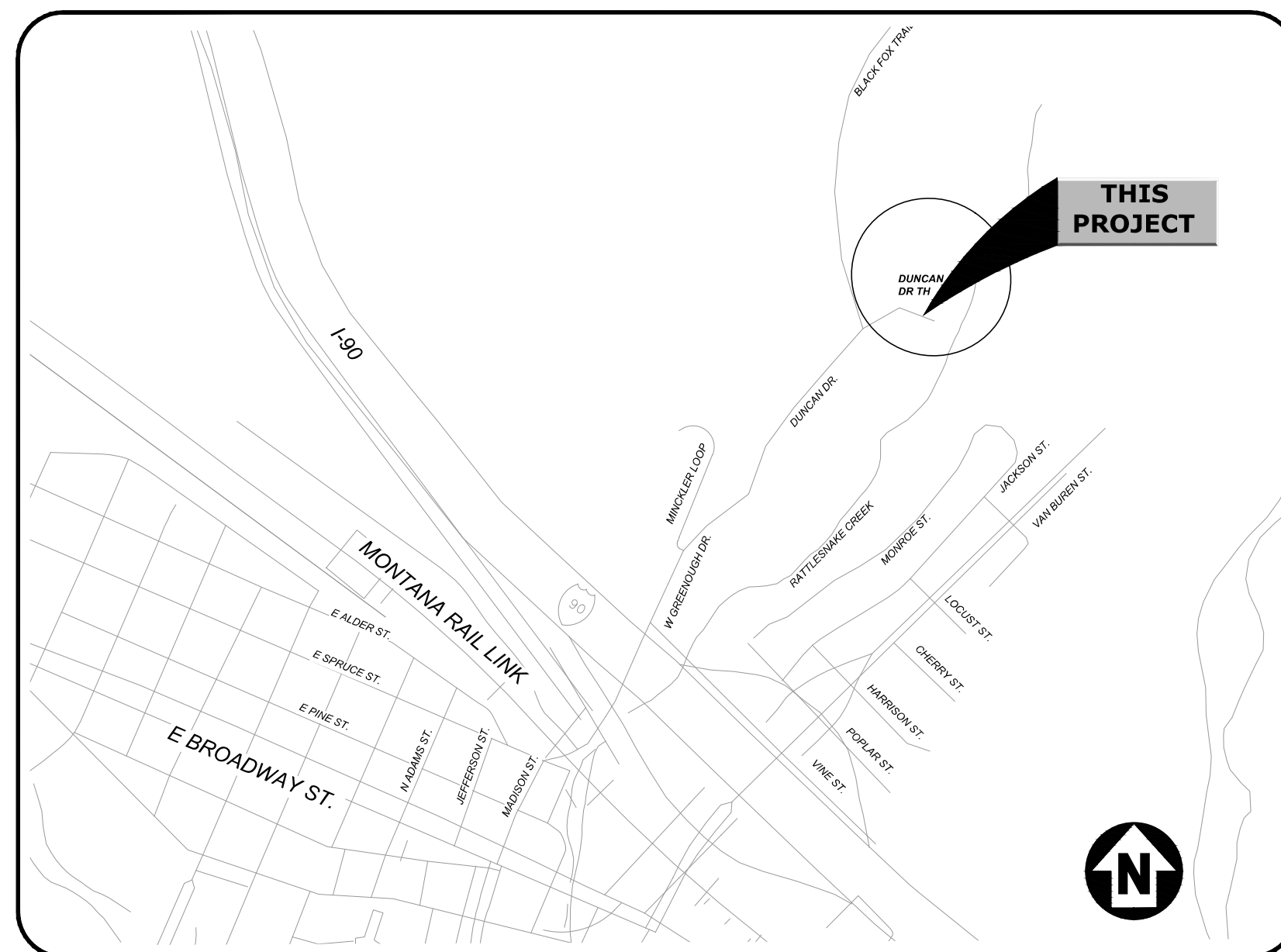

AREA MAP
No Scale



CALL
TWO WORKING DAYS
BEFORE YOU DIG
(ID, MT, ND, OR, WA, WY)

CALL 1-800-424-5555
UNDERGROUND UTILITIES LOCATION CENTER

WITH THE FOLLOWING:

COUNTY MISSOULA CITY MISSOULA

PROPERTY ADDRESS NO ASSIGNED ADDRESS

SEC. NO.# S02

TOWNSHIP & RANGE T13 N & R19 W

ENGINEERING CONTACT:

| | |
|--|---------------------|
| KYLE GAUTHIER, P.E. (406) 721-4320 | PRINCIPLE-IN-CHARGE |
| EMILY GILLESPIE, P.E. (406) 721-4320 | PROJECT MANAGER |
| KYLE DRUYVESTEIN, E.I. (406) 721-4320 | DESIGN ENGINEER |





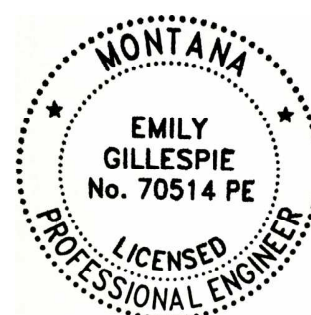





**ENGINEERS
PLANNERS
SURVEYORS**



Emily Gillespie
07.01.2025

EXISTING - LINE TYPE LEGEND

| | |
|---|---|
|  | SURVEY PROJECT MAIN PROPERTY LOT LINE |
|  | SURVEY ADJACENT LOT PROPERTY LINE |
|  | SURVEY RIGHT OF WAY LINE |
|  | EDGE OF ASPHALT |
|  | EDGE OF GRAVEL/ DIRT ROAD |
|  | ROAD/SITE/PARKING STRIPING |
|  | ROAD SHOULDER |
|  | CULVERT PIPE - 2D MULTI LINE FOR PLANIMETRIC ONLY |
|  | GATE |
|  | OVERHEAD POWER LINE |
|  | UNDERGROUND TELEPHONE LINE |
|  | MAJOR CONTOUR LINE WITH CONTOUR LABEL |
|  | MINOR CONTOUR LINE |
|  | DRAINAGE DITCH OR SWALE |
|  | BARB WIRE TYPE SPECIFIC |
|  | ASPHALT HATCH & ASPHALT EDGE |
|  | GRAVEL/DIRT HATCH & GRAVEL/DIRT EDGE |

SYMBOLLOGY

| | |
|---|---|
|  | OVERHEAD UTILITY POLE |
|  | TELEPHONE/COMMUNICATIONS PEDESTAL |
|  | ROUND STORM SUMP OR CATCH BASIN - OPEN INFLOW LID |
|  | MISCELLANEOUS MANHOLE |
|  | ADA DESIGNATED PARKING SPOT |
|  | SIGN (SINGLE POST) |
|  | SIGN (MULTIPLE POSTS) |
|  | ROAD SIGN - DELINEATOR |
|  | GUY WIRE (THE GROUND CONNECTION POINT) |
|  | CONIFEROUS TREE (AS NOTED) |
|  | MAILBOX LOCATION |
|  | ROCK RETAINER |
|  | CONCRETE WHEELSTOP |
|  | SURVEY CONTROL POINT |
|  | LANDSCAPE BOULDER |
|  | 3 PANEL KIOSK |

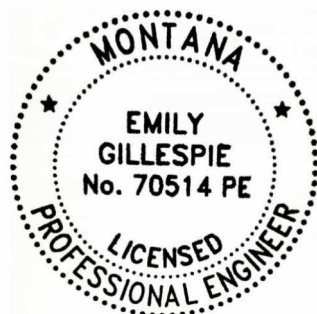

Erin Gillespie
06.12.2025

PROPOSED - LINE TYPE LEGEND

LIMITS OF DISTURBANCE
 EDGE OF AGGREGATE
 EDGE OF ASPHALT
 FENCE - JACK-LEG FENCE
 EDGE OF GRAVEL/ DIRT ROAD
 MAJOR CONTOUR LINE WITH CONTOUR LABEL
 MINOR CONTOUR LINE
 STORMWATER SWALE/DEPRESSION
 AGGREGATE HATCH & AGGREGATE EDGE
 ASPHALT MILLING HATCH & ASPHALT MILLING EDGE
 ASPHALT HATCH & ASPHALT EDGE

GENERAL NOTES

1. SPECIFICATIONS: THE PROJECT IN COMPLIANCE WITH THE PROJECT SPECIFICATIONS, THE CITY OF MISSOULA STANDARD DETAILS AND DRAWINGS, AND THE MCPWSS MANUAL. THE PROJECT SPECIFICATIONS ARE DERIVED FROM THE MONTANA PUBLIC WORKS STANDARD SPECIFICATIONS (MPWSS) AND HAVE BEEN REVISED AND SUPPLEMENTED FOR THIS PROJECT.
2. DRAWING COORDINATE SYSTEM: MONTANA (2500)
DRAWING UNITS: INT. FEET
DRAWING HORIZONTAL/GEOMETRIC DATUM: NAD83
DRAWING VERTICAL DATUM: NAVD 88
GEIOD: 18
HELD CP-1 WITH OPUS POST-PROCESSED POSITION FOR HZ AND VT. BROUGHT TO GROUND AT CP-1. CSF=0.99922989.
3. DISPOSAL: ALL MATERIALS DESIGNATED FOR REMOVAL BECOME THE PROPERTY OF THE CONTRACTOR UPON REMOVAL AND ARE TO BE DISPOSED OF IN AN ENVIRONMENTALLY SAFE MANNER IN ACCORDANCE WITH ALL LOCAL, STATE AND FEDERAL REQUIREMENTS. PROPER DISPOSAL OF MATERIALS DESIGNATED FOR REMOVAL ARE INCIDENTAL TO OTHER ITEMS IN THE CONTRACT UNLESS OTHERWISE NOTED.
4. EXISTING UTILITIES: UTILITY LOCATIONS SHOWN ON THE PLANS ARE APPROXIMATE. NOT ALL UTILITIES ARE SHOWN. IT IS THE RESPONSIBILITY OF THE CONTRACTOR TO VERIFY LOCATIONS OF ALL UTILITIES THAT MAY BE IMPACTED BY THIS PROJECT. REFER TO PROJECT SPECIFICATION SECTION 01041 FOR UTILITY COMPANY CONTACT INFORMATION AND COORDINATION REQUIREMENTS.
5. COORDINATION WITH LANDOWNERS: IT IS THE RESPONSIBILITY OF THE CONTRACTOR TO COORDINATE WITH LANDOWNERS AND BUSINESS OWNERS ADJACENT TO THE PROJECT TO SCHEDULE WORK THAT MAY AFFECT ACCESS TO THEIR PROPERTIES.
6. SETTING SIGNS: SET STREET SIGNS IN ACCORDANCE WITH THE PROJECT SPECIFICATIONS, THE CITY OF MISSOULA STANDARD DETAILS, AND COMMUNITY DEVELOPMENT PLANNING AND INNOVATION (CDPI). THE CONTRACTOR SHALL CONTACT CHAD PANCAKE, CITY OF MISSOULA TRAFFIC SERVICES, AT (406) 552-6372, TO COORDINATE SIGN INSTALLATION PROCEDURES AND SIGN LOCATIONS PRIOR TO INSTALLATION OF ALL SIGNS.
7. PERMIT COSTS: CITY OF MISSOULA DEVELOPMENT SERVICES WILL CALCULATE PERMIT COSTS, CONTRACTOR TO VERIFY.
8. PLOT IN COLOR: PLANS ARE MEANT TO BE PLOTTED IN COLOR, LINES MAY BE SHOWN IN RED TO INDICATE DEMOLITION ACTIVITY.
9. EVERY ATTEMPT HAS BEEN MADE TO ENSURE THE ACCURACY OF THE DRAWINGS THROUGH FIELD VERIFICATION. IT IS THE RESPONSIBILITY OF THE CONTRACTOR TO VERIFY EXISTING CONDITIONS, SIZES, QUANTITIES, & TO COORDINATE ALL ASPECTS OF THE PROJECT BEFORE CONSTRUCTION, ORDERING, AND INSTALLATION OF ANY COMPONENT. NOTIFY THE CITY IMMEDIATELY FOR WRITTEN CLARIFICATION IF ANY DISCREPANCY EXISTS.
10. DRAWINGS CONTAINED WITHIN THESE DOCUMENTS ARE ABBREVIATED IN NATURE. THE CONTRACTOR IS EXPECTED TO USE QUALITY, ACCEPTABLE, CONSTRUCTION PRACTICES & TECHNIQUES FOR THE EXTENT AND TYPE OF WORK DESCRIBED HEREIN.
11. CONTRACTOR IS TO REFER TO ALL DRAWINGS, SPECIFICATIONS, AND REQUIREMENTS OF CONTRACT INCLUDED FOR DESCRIPTION OF THE WORK. CONTRACTOR IS RESPONSIBLE FOR COORDINATION OF ALL REQUIREMENTS AMONG THE DRAWINGS, SPECIFICATIONS, REQUIREMENTS OF CONTRACT, THE WORK OF ALL THEIR EMPLOYEES, SUB-CONTRACTORS, SUB-SUB-CONTRACTORS, AND ANY PERSON OR TRADE PARTICIPATING IN ANY ASPECT OF WORK.
12. THE CONTRACTOR SHALL NOT INTRODUCE OR TRANSPORT EXOTIC OR NON-NATIVE PLANTS INTO THE PROJECT AREA.
13. STRIP TOPSOIL AND STOCKPILE FOR REPLACEMENT AS SPECIFIED IN ALL AREAS OF EXCAVATION OR DISTURBANCE. STOCKPILE ANY EXCESS TOPSOIL IN THE LOCATION SHOWN ON THE PLANS.
14. RESTORE ALL SURFACES DISTURBED AS SPECIFIED AND SHOWN ON THE CONSTRUCTION DRAWINGS.
15. ALL MINOR OBSTRUCTIONS MAY NOT BE SHOWN ON THE PROJECT PLANS. THE CONTRACTOR SHALL REVIEW THE SITE PLANS AND DETERMINE THE CONDITIONS WITH REGARD TO THE EXISTENCE OF TREES, BOULDERS, SIDEWALKS, CULVERTS, UTILITIES, AND OTHER SITE IMPROVEMENTS AND MISC. OBSTACLES THAT MAY INTERFERE WITH CONSTRUCTION PRIOR TO SUBMITTING PROPOSALS.

| REVISION | DATE | DESCRIPTION |
|----------|------|-------------|
| - | - | - |
| - | - | - |
| | | |
| | | |
| | | |
| | | |

DESIGNER KD PROJ. NO. 7603
DRAWN KD DATE 06.12.2025
CHECKED EG SURVEYED DJ&A P.C.



DUNCAN DRIVE TRAILHEAD
MISSOULA, MONTANA

GENERAL NOTES & LEGEND

SHEET
OF
2 12

ABBREVIATIONS

| | | | |
|--------------------------------|---------------------|--------------------------------|----------------|
| ALTERNATE | alt. | FRONT FACE OF CURB PAN | FF |
| AND | & | FLOW LINE | FL |
| AND SO FORTH (ET CETERA) | etc. | QUANTITIES | quant. |
| APPROXIMATE | approx. | RADIUS | R |
| ASPHALT | asph. | RADIUS POINT | RAD PT. |
| AT | @ | RAIL ROAD | R-R |
| BEGIN VERTICAL CURVE ELEVATION | BVCE | RED PLASTIC CAP | RPC |
| BEGIN VERTICAL CURVE STATION | BVCS | REQUIRED | reqd. |
| BENCH MARK | BM | RECYCLED ASPHALT PAVEMENT | RAP |
| BLUE PLASTIC CAP | BPC | RIGHT | RT |
| CENTERLINE | CL, C/L | RIGHT-OF-WAY | R/W |
| CLEAR | clr. | ROAD | rd. |
| CONTROL POINT | CP | SECOND (ANGULAR) | " |
| CORRUGATED | corr. | SIDEWALK | s/w |
| CORRUGATED METAL PIPE | CMP | SOUTH | S |
| CUBIC YARD | CY | SPECIFICATION | spec. |
| CUBIC FEET | ft³, cf | SQUARE | sq |
| CULVERT | culv. | SQUARE FOOT | ft², ft2 or sf |
| CURVE DELTA | Δ | SQUARE YARD | SY |
| DEGREE | °, deg. | STANDARD | std |
| DIAMETER | dia., D, Ø | STREET | St |
| DRAWING(S) | drwg(s). | STATION | STA |
| DRIVE | dr | SUPERELEVATION RATE | e |
| EACH | each | SYMMETRICAL | sym. |
| EAST | E | TANGENT | tan. |
| ELEVATION | elev., el. | TEMPORARY BENCH MARK | TBM |
| ENGINEER(S) | engr(s). | TOP BACK OF CURB | TBC |
| END VERTICAL CURVE ELEVATION | EVCE | TYPICAL | typ. |
| END VERTICAL CURVE STATION | EVCS | VERTICAL CURVE LENGTH | VC |
| EXCAVATION | exc. | VERTICAL POINT OF INTERSECTION | VPI |
| EXPANSION JOINT | exp. jt. | WEST | W |
| FINISHED GRADE | FG | | |
| FOOT (MEASUREMENT) | ft. or ' | | |
| FOUND | FND | | |
| GALVANIZED GAGE (GAUGE) | galv. ga. | | |
| HEXAGON | hex. | | |
| INSIDE DIAMETER | ID | | |
| INVERT | Inv. | | |
| INVERT ELEVATION | IE | | |
| LEFT | LT | | |
| LENGTH OF CURVE | L | | |
| LINEAL FOOT | LF | | |
| LIMITS OF DISTURBANCE | LOD | | |
| LOOP | LP | | |
| LUMP SUM | LS | | |
| MILES | m | | |
| MAXIMUM | max. | | |
| MINUTE(S) (ANGULAR) | ' | | |
| MINIMUM | min. | | |
| MISCELLANEOUS | misc. | | |
| MONUMENT | mon. | | |
| NORMAL CROWN | nc | | |
| NORTH | N | | |
| NUMBER | no. | | |
| OUTSIDE DIAMETER | OD | | |
| PAVEMENT | pvm. | | |
| PERCENT | pct. or % | | |
| PERFORATE | perf. | | |
| POINT OF COMPOUND CURVE | PCC | | |
| POINT OF CURVE | PC | | |
| POINT ON CURVE | POC | | |
| POINT OF INTERSECTION | PI | | |
| POINT OF REVERSE CURVE | PRC | | |
| POINT ON TANGENT | POT | | |
| POINT OF TANGENT | PT | | |
| POINT OF VERTICAL INTERSECTION | PVI | | |
| QUANTITIES | quant. | | |
| SCHEDULE | sch. | | |
| SLOPE DESIGNATION | horizontal:vertical | | |



Erin Gillespie
06.12.2021

| REVISION | DATE | DESCRIPTION |
|----------|------|-------------|
| - | - | - |
| - | - | - |
| | | |
| | | |
| | | |
| | | |

DESIGNER KD PROJ. NO. 7603
DRAWN KD DATE 06.12.2025
CHECKED EG SURVEYED DJA P.C.

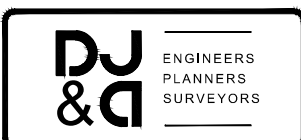

DUNCAN DRIVE TRAILHEAD MISSOULA, MONTANA

ABBREVIATIONS

| | |
|-------|----|
| SHEET | |
| OF | |
| 3 | 12 |

SUMMARY OF ESTIMATED PROJECT QUANTITIES

| ITEM NO. | ITEM DESCRIPTION | UNIT | QUANTITY |
|----------|--------------------------------|------|----------|
| M1 | MOBILIZATION | LS | 1 |
| M2 | TEMPORARY CONSTRUCTION FENCING | LS | 1 |
| M3 | MISCELLANEOUS WORK | LS | 1 |

| ITEM NO. | ITEM DESCRIPTION | UNIT | QUANTITY |
|----------|--|------|----------|
| A1 | TEMPORARY TRAFFIC CONTROL | LS | 1 |
| A2 | SOIL EROSION AND POLLUTION CONTROL | LS | 1 |
| A3 | CLEARING AND GRUBBING | LS | 1 |
| A4 | REMOVE EXISTING BITUMINOUS PAVEMENT | SY | 9 |
| A5 | REMOVE EXISTING TREE STUMPS | EA | 9 |
| A6 | REMOVE EXISTING GATE | EA | 1 |
| A7 | REMOVE EXISTING FENCING | LF | 200 |
| A8 | EARTHWORK | LS | 1 |
| A9 | CRUSHED AGGREGATE COURSE, 3/4" MINUS (PARKING LOT) | CY | 170 |
| A10 | ASPHALT MILLINGS (PARKING AREA, 5" THICK) | SF | 3130 |
| A11 | ASPHALT PAVEMENT (ROADWAY, 3" THICK) | SF | 6010 |
| A12 | TENSAR NX750 GEOGRID | SF | 9140 |
| A13 | NON-WOVEN GEOTEXTILE | SF | 9140 |
| A14 | CRUSHED AGGREGATE COURSE, 3/4" MINUS (PLAZA + TRAIL) | CY | 17 |
| A15 | CONCRETE WHEELSTOP | EA | 16 |
| A16 | PAVEMENT MARKINGS, ROADWAY/PARKING LOT | LS | 1 |
| A17 | ONE WAY SIGN SYSTEM | EA | 1 |
| A18 | ADA PARKING SIGN SYSTEM | EA | 1 |
| A19 | TOPSOIL PLACEMENT | SY | 1150 |

NOTE: LUMPSUM EARTHWORK TO INCLUDE ANY OVER EXCAVATION AND REMOVAL OF UNSUITABLE SOIL PER THE GEOTECHNICAL REPORT, SEE GRADING PLAN FOR ADDITIONAL INFORMATION.

* COMPACTED IN-PLACE. NOT FULLY ADJUSTED FOR SHRINK/SWELL.

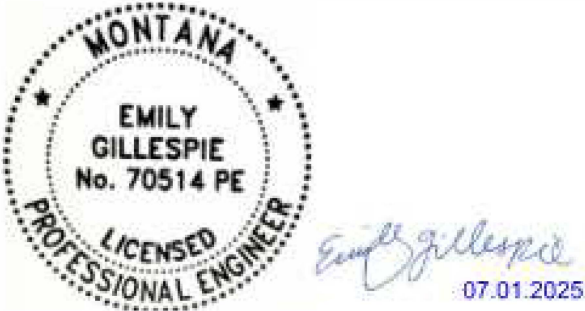

| REVISION | DATE | DESCRIPTION |
|----------|------|-------------|
| | | |
| | | |
| | | |
| | | |
| | | |

| | | | |
|----------|----|-----------|------------|
| DESIGNER | KD | PROJ. NO. | 7603 |
| DRAWN | KD | DATE | 06.12.2025 |
| CHECKED | EG | SURVEYED | DJA P.C. |

DJ&C

ENGINEERS
PLANNERS
SURVEYORS

DUNCAN DRIVE TRAILHEAD
MISSOULA, MONTANA

PROJECT QUANTITIES

| SHEET | OF |
|-------|----|
| 4 | 12 |

THIS IS A PRELIMINARY DESIGN. IT IS NOT TO BE USED FOR CONSTRUCTION. ANY CHANGES TO THE DESIGN SHALL BE MADE BY THE DESIGNER. THE DESIGNER IS NOT RESPONSIBLE FOR THE ACCURACY OF THE QUANTITIES SHOWN HEREIN.

DEMOLITION NOTES:

- 1. CONTRACTOR TO VERIFY EXISTING CONDITIONS PRIOR TO COMMENCEMENT OF WORK.
- 2. CONTRACTOR TO DISPOSE OF ALL MATERIALS OFFSITE AND IN ACCORDANCE WITH ALL GOVERNING AGENCIES REQUIREMENTS. SEE NOTE ON SHEET 3 FOR TOPSOIL REQUIREMENTS.
- 3. SITE IS TO BE CLEARED AND GRUBBED UP TO 3' FROM THE EDGE OF ASPHALT OR EDGE OF AGGREGATE.
- 4. PLANS ARE TO BE PLOTTED IN COLOR, ITEMS SHOWN IN RED ARE MEANT TO SHOW DEMOLITION WORK.
- 5. CONTRACTOR TO PROVIDE TRAFFIC CONTROL FOR TRUCKS ENTERING AND EXITING THE AREA.

CONTROL POINT TABLE

| POINT # | NORTHING | EASTING | ELEVATION | DESCRIPTION |
|---------|------------|-----------|-----------|-------------------------------|
| CP-1 | 1001382.24 | 852437.21 | 3490.78 | FOUND 2" AC |
| CP-2 | 1001303.37 | 852637.07 | 3490.39 | SET MAG NAIL |
| CP-5 | 1001570.22 | 853041.15 | 3501.66 | FOUND 3 1/4" AC ON 5/8" REBAR |

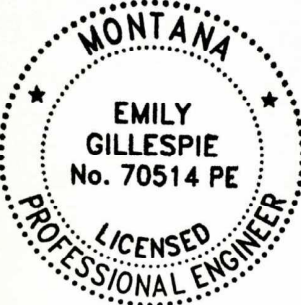
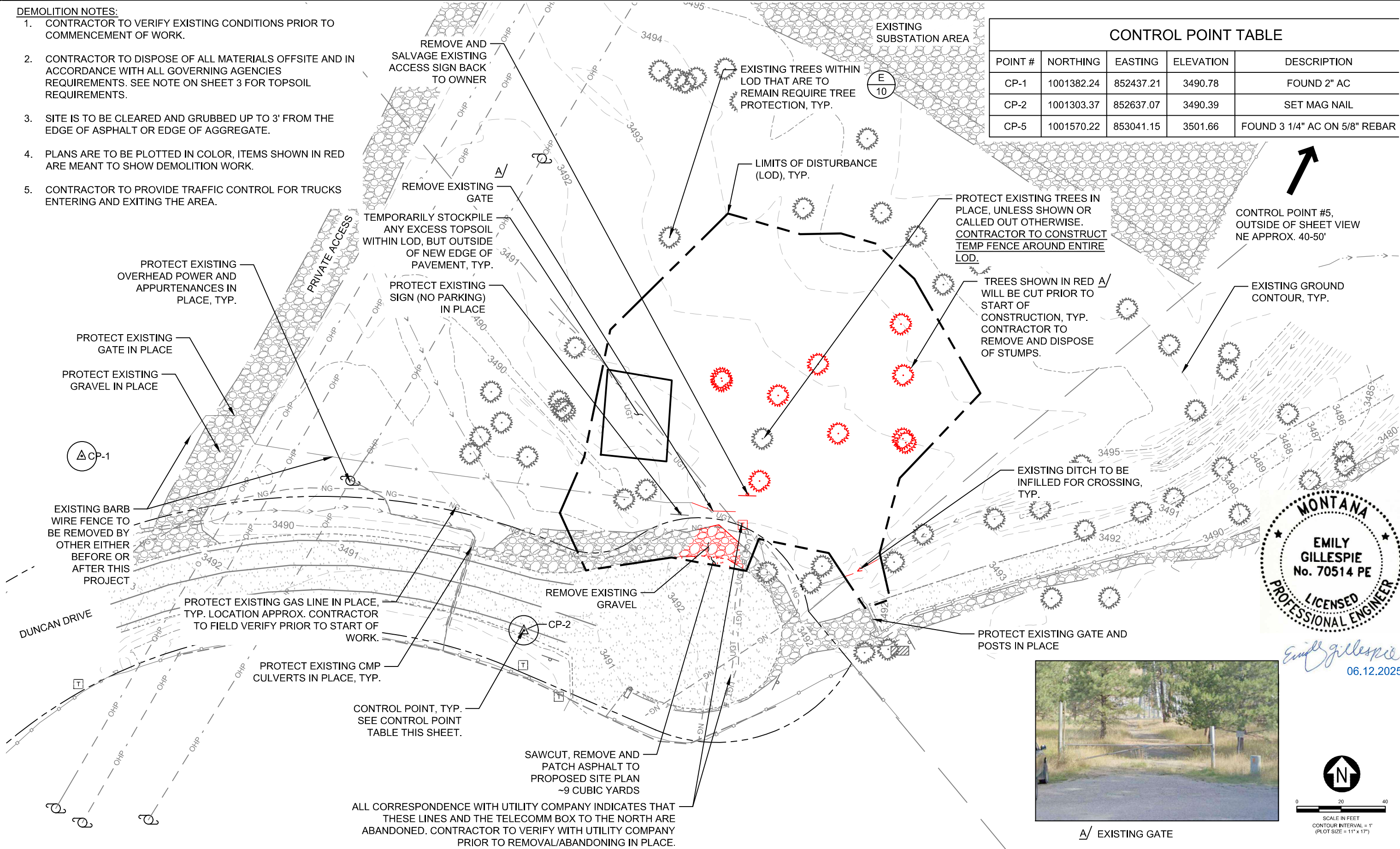

Emily Gillespie
06.12.2025



A/ EXISTING GATE

| REVISION | DATE | DESCRIPTION |
|----------|------|-------------|
| | | |
| | | |
| | | |
| | | |

| | | | |
|----------|----|-----------|------------|
| DESIGNER | KD | PROJ. NO. | 7603 |
| DRAWN | KD | DATE | 06.12.2025 |
| CHECKED | EG | SURVEYED | DJA P.C. |



DUNCAN DRIVE TRAILHEAD
MISSOULA, MONTANA

DEMOLITION PLAN

| | |
|-------|----|
| SHEET | OF |
| 5 | 12 |

SITE NOTES:

1. UTILITIES SHOWN ON THE PLANS ARE APPROXIMATE. IT IS THE RESPONSIBILITY OF THE CONTRACTOR TO VERIFY LOCATIONS OF ALL UTILITIES WITHIN THE PROJECT LIMITS.
2. CONTRACTOR TO SAW CUT, TACK AND JOIN BETWEEN EXISTING AND PROPOSED ASPHALT SECTIONS.
3. WORK BY OTHERS IS SHOWN WITHIN THE PROPOSED DISTURBANCE LIMITS, CONTRACTOR WILL NOT BE RESPONSIBLE FOR WORK CALLED OUT TO BE DONE BY OTHERS. WORK BY OTHERS IS GRAYED BACK AND SHOWN FOR CONCEPTUAL UNDERSTANDING ONLY.
4. CONTRACTOR STAGING AND STOCKPILING OF MATERIALS IS APPROVED WITHIN LIMITS OF DISTURBANCE.

EXERCISE CAUTION WHEN OPERATING AROUND POWER POLE, PROTECT IN PLACE.

FUTURE AGGREGATE TRAIL BY OTHERS

EXISTING GROUND CONTOUR, TYP.

JACK-LEG FENCE BY OTHERS, TYP.

TOPSOIL PLACEMENT ALL DISTURBED AREAS PER GRADING PLAN. SEEDING BY OTHERS

74' MAINTAIN DISTANCE AWAY FROM SUB STATION

LANDSCAPE BOULDER BY OTHERS, TYP.

ASPHALT ROADWAY, TYP.

DEPRESSED SWALE/DRAINAGE AREA, SEE GRADING PLAN

CONCRETE WHEEL STOP, TYP.

AGGREGATE SIDEWALK

ADA STALLS (2 VAN ACCESSIBLE)

3 PANEL SIGN BY OTHERS

TIE AGGREGATE SIDEWALK TO EXISTING EDGE OF ASPHALT

MUTT-MITT BY OTHERS

BEAR BOX BY OTHERS

TIE TO EXISTING AT SAWCUT LINE PER MISSOULA STD-744, SEE SHEET 11

BIKE RACK BY OTHERS

LANDSCAPE BOULDER BY OTHERS, TYP.

NON TRAFFIC RELATED SIGNAGE BY OTHERS, SEE SIGNAGE PLAN

STOCKPILE ANY EXCESS TOPSOIL WITHIN LOD, BUT OUTSIDE OF NEW EDGE OF PAVEMENT, TYP.

NOTE: LOD DECREASE AFTER DEMOLITION WORK TO LIMITS SHOWN ON THIS SHEET

LIMITS OF DISTURBANCE, TYP.

ASPHALT MILLING PARKING AREA, TYP.

D 10

C 10

A 10

E 10

B 10

C 11

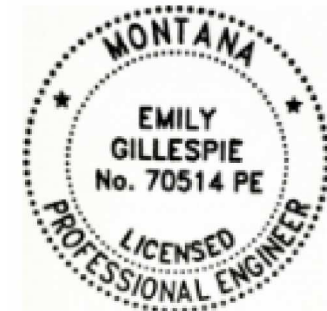

07.01.2025

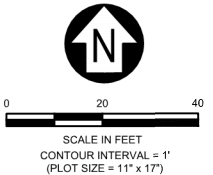

| REVISION | DATE | DESCRIPTION |
|----------|------|-------------|
| | | |
| | | |
| | | |
| | | |
| | | |

| | | | |
|----------|----|-----------|------------|
| DESIGNER | KD | PROJ. NO. | 7603 |
| DRAWN | KD | DATE | 06.12.2025 |
| CHECKED | EG | SURVEYED | DJA P.C. |

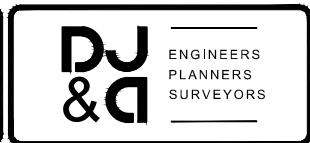

DUNCAN DRIVE TRAILHEAD
MISSOULA, MONTANA

SITE PLAN OVERVIEW

| | |
|-------|----|
| SHEET | OF |
| 6 | 12 |

GRADING NOTES:

- 1. CONTRACTOR TO ENSURE ADA COMPLIANCE AT ADA PARKING STALLS, ACCESS AISLE AND SIDEWALKS.
- 2. A GEOTECHNICAL REPORT IS AVAILABLE FOR CONTRACTOR USE AND REVIEW.
- 3. AGGREGATE SIDEWALKS TO HAVE A MAX 2% CROSS SLOPE AND A MAX 5% RUNNING SLOPE.
- 4. ADA PARKING AREAS TO BE MAX 2% ALL DIRECTIONS.
- 5. MAXIMUM GRADE FROM EDGE OF IMPROVEMENTS TO LOD IS 1V:3H.



Emily Gillespie
06.12.2025

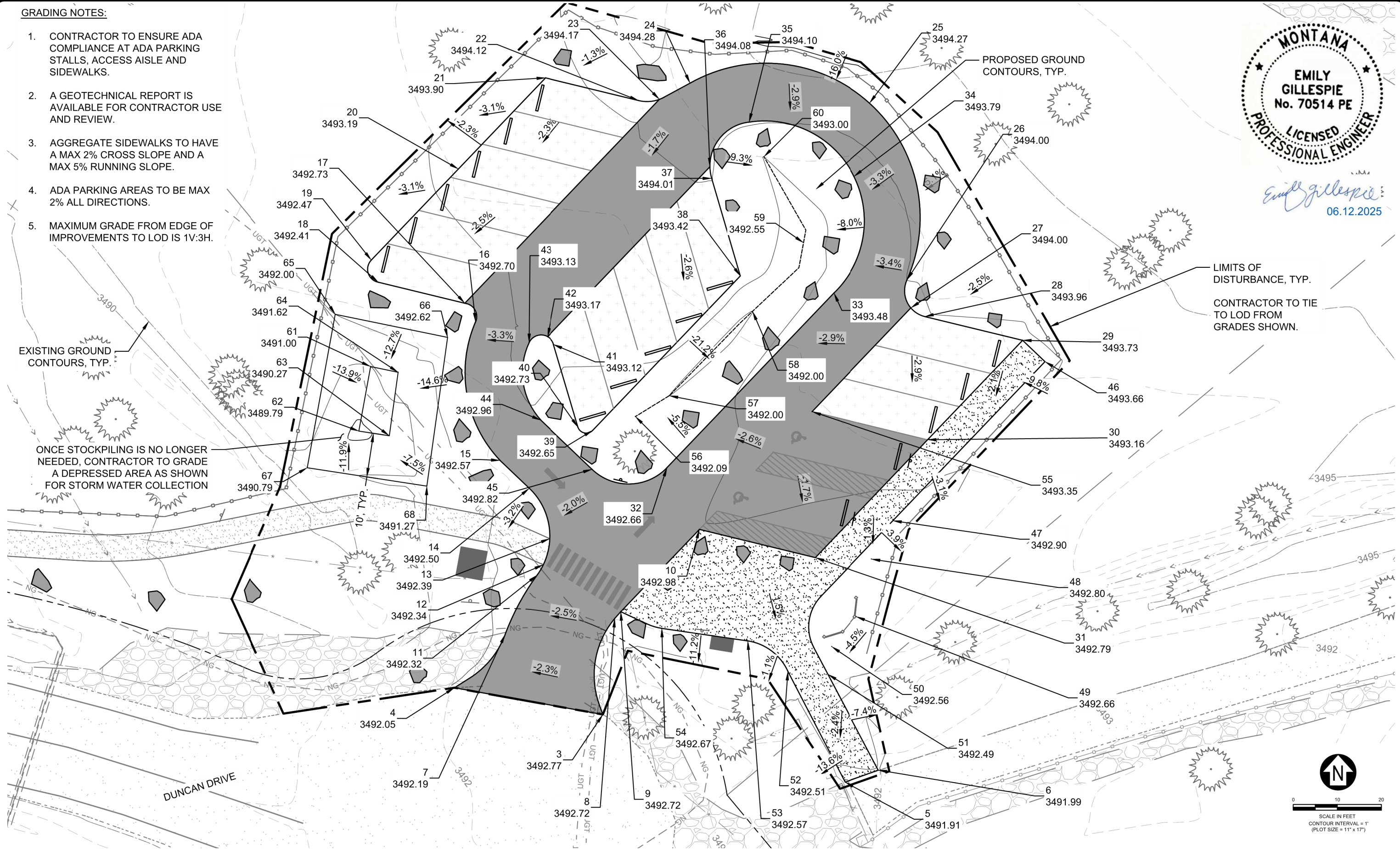

| REVISION | DATE | DESCRIPTION |
|----------|------|-------------|
| | | |
| | | |
| | | |
| | | |
| | | |

| | | | |
|----------|----|-----------|------------|
| DESIGNER | KD | PROJ. NO. | 7603 |
| DRAWN | KD | DATE | 06.12.2025 |
| CHECKED | EG | SURVEYED | DJ&A P.C. |



DUNCAN DRIVE TRAILHEAD
MISSOULA, MONTANA

GRADING PLAN

| | |
|-------|----|
| SHEET | OF |
| 7 | 12 |

6102518-48-KITE-PRINTING-ENGINEERING-C:\JAMES\WORK\04-PROJ\04-05-25\04-05-25-01-B-CRADING PLANTING

| POINT TABLE | | | | |
|-------------|------------|-----------|-----------|-----------------|
| POINT # | NORTHING | EASTING | ELEVATION | DESCRIPTION |
| 3 | 1001330.32 | 852737.56 | 3492.77 | TIE TO EXISTING |
| 4 | 1001336.39 | 852703.83 | 3492.05 | TIE TO EXISTING |
| 5 | 1001314.98 | 852792.43 | 3491.91 | TIE TO EXISTING |
| 6 | 1001317.71 | 852799.98 | 3491.99 | TIE TO EXISTING |
| 7 | 1001348.48 | 852715.32 | 3492.19 | EOA |
| 8 | 1001352.11 | 852740.24 | 3492.72 | EOA |
| 9 | 1001353.64 | 852741.60 | 3492.72 | EOA |
| 10 | 1001372.29 | 852759.41 | 3492.98 | EOA |
| 11 | 1001361.92 | 852722.55 | 3492.32 | EOA |
| 12 | 1001364.28 | 852723.95 | 3492.34 | EOA |
| 13 | 1001370.20 | 852725.42 | 3492.39 | EOA |
| 14 | 1001381.61 | 852720.79 | 3492.50 | EOA |
| 15 | 1001387.94 | 852714.16 | 3492.57 | EOA |
| 16 | 1001419.39 | 852708.62 | 3492.70 | EOA |
| 17 | 1001423.59 | 852706.19 | 3492.73 | EOA/EOAM |
| 18 | 1001428.36 | 852686.58 | 3492.41 | EOAM |
| 19 | 1001433.37 | 852685.00 | 3492.47 | EOAM |
| 20 | 1001454.05 | 852704.74 | 3493.19 | EOAM |
| 21 | 1001474.72 | 852724.47 | 3493.90 | EOAM |
| 22 | 1001469.56 | 852745.65 | 3494.12 | EOAM |
| 23 | 1001469.85 | 852750.36 | 3494.17 | EOA/EOAM |
| 24 | 1001473.50 | 852757.28 | 3494.28 | EOA |
| 25 | 1001468.96 | 852798.02 | 3494.27 | EOA |
| 26 | 1001428.84 | 852806.48 | 3494.00 | EOA |
| 27 | 1001422.53 | 852807.38 | 3494.00 | EOAM |

| POINT TABLE | | | | |
|-------------|------------|-----------|-----------|-------------|
| POINT # | NORTHING | EASTING | ELEVATION | DESCRIPTION |
| 28 | 1001420.57 | 852810.55 | 3493.96 | EOAM |
| 29 | 1001415.18 | 852832.69 | 3493.73 | EOA/EOT |
| 30 | 1001392.63 | 852811.16 | 3493.16 | EOA/EOT |
| 31 | 1001365.90 | 852785.67 | 3492.79 | EOA |
| 32 | 1001386.32 | 852752.06 | 3492.66 | EOA |
| 33 | 1001425.92 | 852789.88 | 3493.48 | EOA |
| 34 | 1001452.34 | 852794.47 | 3493.79 | EOA |
| 35 | 1001464.66 | 852770.66 | 3494.10 | EOA |
| 36 | 1001454.55 | 852761.79 | 3494.08 | EOA/EOAM |
| 37 | 1001451.91 | 852762.19 | 3494.01 | EOAM |
| 38 | 1001429.78 | 852768.67 | 3493.42 | EOAM |
| 39 | 1001394.75 | 852735.23 | 3492.65 | EOAM |
| 40 | 1001395.50 | 852731.89 | 3492.73 | EOAM |
| 41 | 1001414.24 | 852726.34 | 3493.12 | EOAM |
| 42 | 1001415.99 | 852724.97 | 3493.17 | EOA/EOAM |
| 43 | 1001414.67 | 852720.75 | 3493.13 | EOA |
| 44 | 1001397.08 | 852723.41 | 3492.96 | EOA |
| 45 | 1001385.92 | 852735.09 | 3492.82 | EOA |
| 46 | 1001410.35 | 852837.76 | 3493.66 | EOT |
| 47 | 1001374.27 | 852803.31 | 3492.90 | EOT |
| 48 | 1001365.57 | 852798.44 | 3492.80 | EOT |
| 49 | 1001352.52 | 852794.99 | 3492.66 | EOT |
| 50 | 1001345.72 | 852789.36 | 3492.56 | EOT |
| 51 | 1001339.43 | 852788.52 | 3492.49 | EOT |
| 52 | 1001340.09 | 852779.45 | 3492.51 | EOT |

| POINT TABLE | | | | |
|-------------|------------|-----------|-----------|-------------|
| POINT # | NORTHING | EASTING | ELEVATION | DESCRIPTION |
| 53 | 1001347.01 | 852770.37 | 3492.57 | EOT |
| 54 | 1001349.86 | 852750.90 | 3492.67 | EOT |
| 55 | 1001399.02 | 852784.93 | 3493.35 | EOA |
| 56 | 1001397.90 | 852744.92 | 3492.09 | FG |
| 57 | 1001402.62 | 852752.58 | 3492.00 | FG |
| 58 | 1001421.73 | 852771.46 | 3492.00 | FG |
| 59 | 1001437.31 | 852782.98 | 3492.55 | FG |
| 60 | 1001456.83 | 852774.03 | 3493.00 | FG |
| 61 | 1001409.23 | 852684.85 | 3491.00 | FG |
| 62 | 1001394.60 | 852682.19 | 3489.79 | FG |
| 63 | 1001393.54 | 852689.09 | 3490.27 | FG |
| 64 | 1001407.94 | 852691.09 | 3491.62 | FG |
| 65 | 1001421.09 | 852676.84 | 3492.00 | FG |
| 66 | 1001415.84 | 852702.28 | 3492.62 | FG |
| 67 | 1001386.28 | 852670.51 | 3490.79 | FG |
| 68 | 1001382.11 | 852697.59 | 3491.27 | FG |

POINT TABLE ABBREVIATIONS:

EOA: EDGE OF ASPHALT

EOAM: EDGE OF ASPHALT MILLINGS

EOT: EDGE OF AGGREGATE TRAIL/PLAZA

FG: FINISHED GRADE

GEOTECHNICAL REPORT INFO:

CONTRACTOR IS TO REVIEW AND FAMILIARIZE THEMSELVES WITH THE GEOTECHNICAL RECOMMENDATIONS FOR THIS PROJECT.

CONTRACTOR TO REMOVE UNSUITABLE TOPSOIL UNDERNEATH THE DRIVE LOOP AND PARKING STALL AREAS AND THEN BACKFILL AS REQUIRED. THIS DEPTH OF UNSUITABLE TOPSOIL VARIES ACROSS THE SITE. ASSUMING AN AVERAGE 12" DEPTH OF REMOVAL RESULTS IN A CUT OF APPROX. 340 CUBIC YARDS. CONTRACTOR SHALL BE PREPARED TO DEAL WITH THIS OVER EX AND BACKFILL OF UNSUITABLE MATERIALS PER THE GEOTECHNICAL REPORT.

Cut/Fill Summary

FOR INFORMATIONAL PURPOSES ONLY, DOES NOT ACCOUNT FOR OVER EX. ONLY COMPARES FINISHED GRADE VS EXISTING GRADE

| Name | Cut Factor | Fill Factor | 2d Area | Cut | Fill | Net |
|----------|------------|-------------|------------------|---------------|----------------|----------------------|
| EG VS FG | 0.800 | 1.200 | 20232.11 Sq. Ft. | 49.71 Cu. Yd. | 203.67 Cu. Yd. | 153.96 Cu. Yd.<Fill> |
| Totals | | | 20232.11 Sq. Ft. | 49.71 Cu. Yd. | 203.67 Cu. Yd. | 153.96 Cu. Yd.<Fill> |

Emily Gillespie
06.12.2025

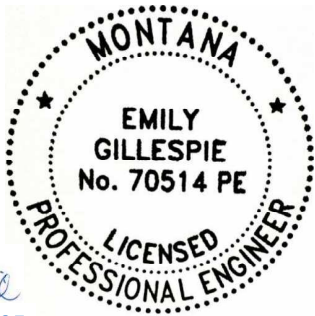

| REVISION | DATE | DESCRIPTION |
|----------|------|-------------|
| - | - | - |
| - | - | - |
| - | - | - |
| - | - | - |
| - | - | - |
| - | - | - |

| | | | |
|----------|---------------|-----------|--------------------------|
| DESIGNER | <u> KD </u> | PROJ. NO. | <u> 7603 </u> |
| DRAWN | <u> KD </u> | DATE | <u> 06.12.2025 </u> |
| CHECKED | <u> EG </u> | SURVEYED | <u> DJ&A P.C. </u> |

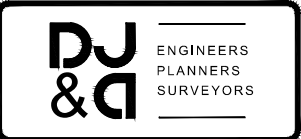

| |
|---|
| DUNCAN DRIVE TRAILHEAD MISSOULA, MONTANA |
|---|

| |
|-------------|
| POINT TABLE |
|-------------|

| |
|-------------|
| SHEET OF |
| 8 12 |

SIGNAGE NOTES:

1. CONTRACTOR OF THIS PROJECT IS RESPONSIBLE FOR TRAFFIC AND ADA SIGNAGE. ALL OTHER SITE SPECIFIC SIGNAGE TO BE CONSTRUCTED OR PROVIDED BY OTHERS.

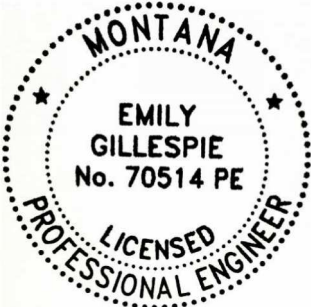
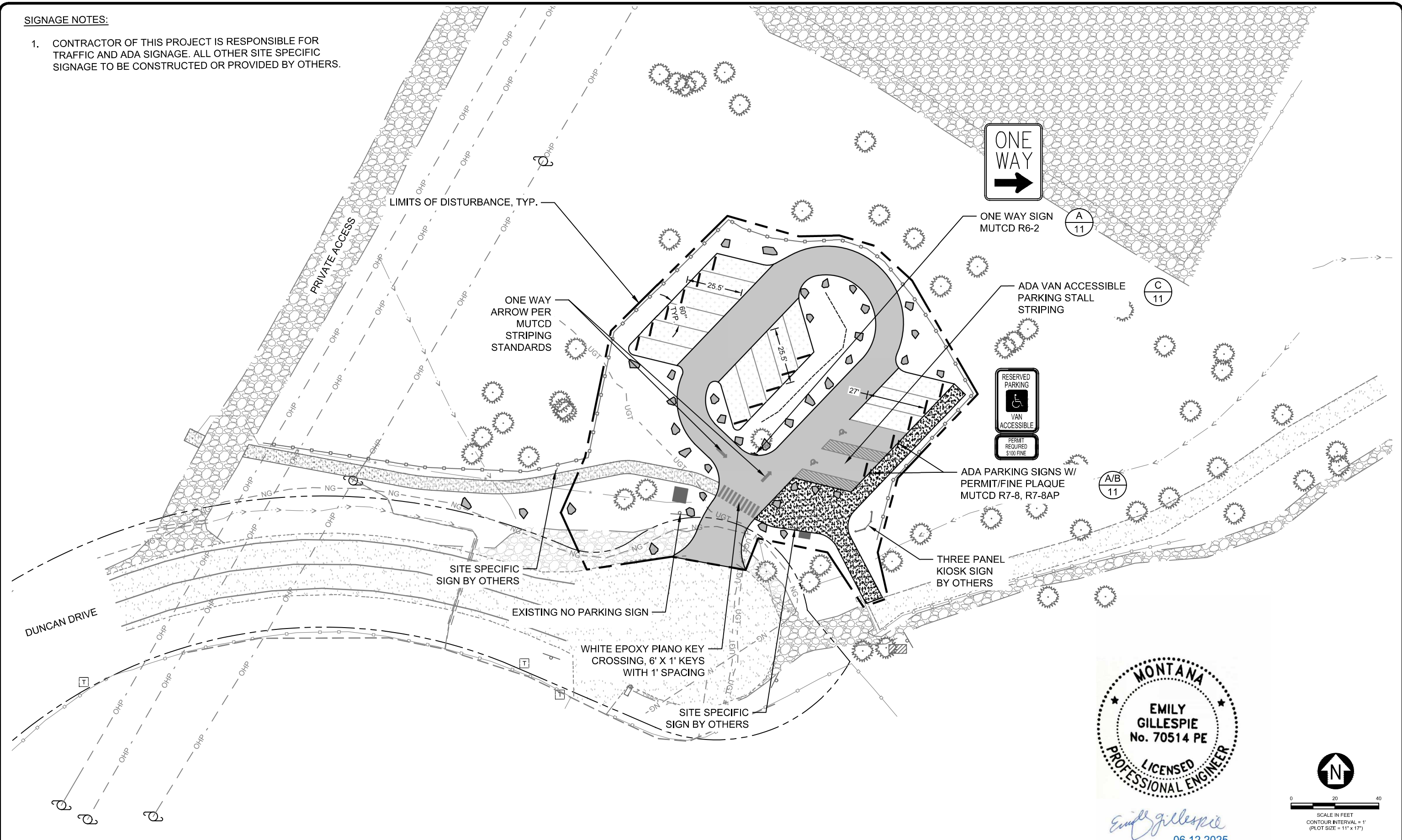

Emily Gillespie
06.12.2025

| REVISION | DATE | DESCRIPTION |
|----------|------|-------------|
| | | |
| | | |
| | | |
| | | |
| | | |

| | | | |
|----------|----|-----------|------------|
| DESIGNER | KD | PROJ. NO. | 7603 |
| DRAWN | KD | DATE | 06.12.2025 |
| CHECKED | EG | SURVEYED | D&A P.C. |

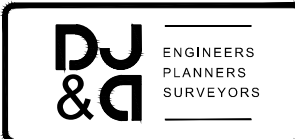

DUNCAN DRIVE TRAILHEAD
MISSOULA, MONTANA

SIGNAGE & STRIPING PLAN

| | |
|-------|----|
| SHEET | OF |
| 9 | 12 |

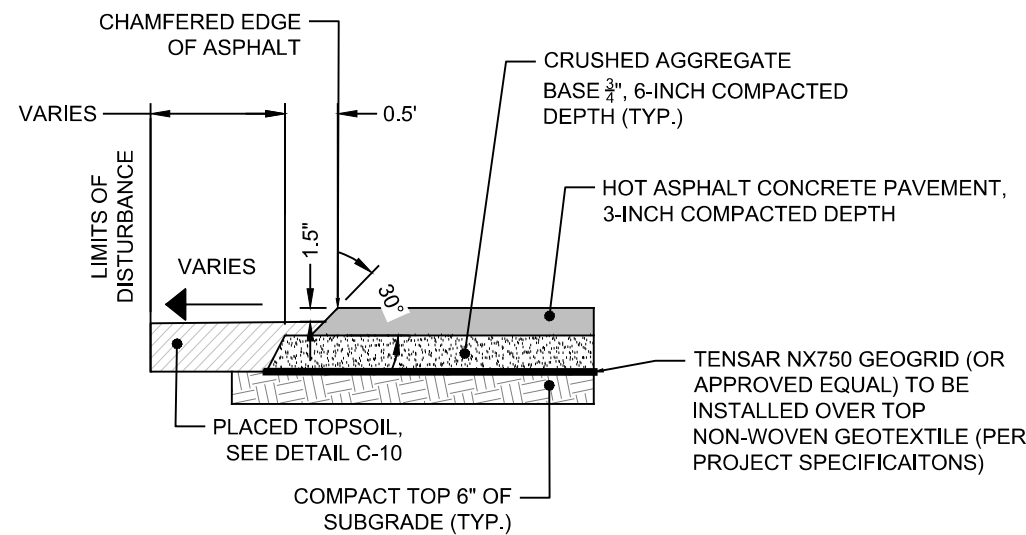

A ASPHALT PAVEMENT SECTION
10 NTS

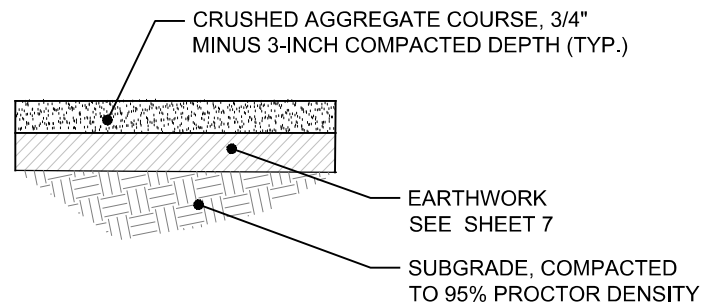

B AGGREGATE TRAIL/PLAZA SECTION
10 NTS

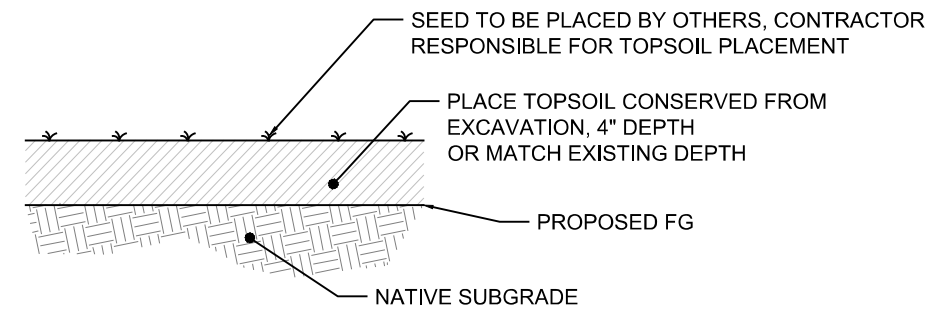

PATCHING NOTES:

1. RE-SEEDING WILL BE COMPLETED BY OTHERS. THE CONTRACTOR WILL BE RESPONSIBLE FOR TOPSOIL PLACEMENT AND GENERAL PREPARATION.
2. NO TOPSOIL TO BE IMPORTED TO PROJECT SITE. TEST HOLES INDICATE ADEQUATE TOPSOIL SUPPLY.

C TOPSOIL SECTION
10 NTS

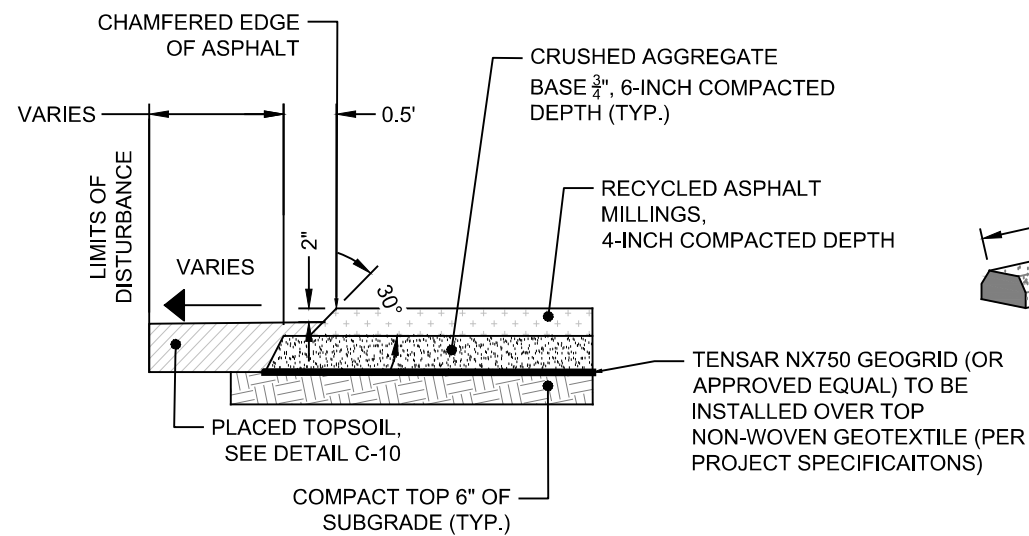

D ASPHALT MILLING SECTION
10 NTS

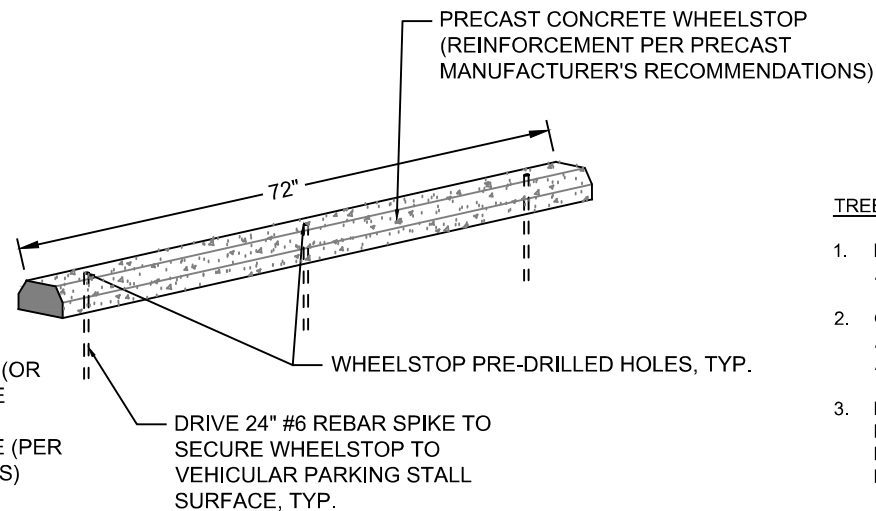

E CONCRETE WHEELSTOP DETAIL
10 NTS

TREE PROTECTION NOTES:

1. REFER TO DEMOLITION PLAN SHEETS 5 FOR TREES THAT ARE NOT BE REMOVED.
2. OUTSIDE EDGE OF TEMPORARY BARRIER SHALL BE PLACED AT DRIP-LINE OF TREE. TREE GUARDS MAY BE PLACED AROUND SINGLE TREES OR GROUPS OF TREES.
3. MOVABLE BARRIERS MAY BE SUBSTITUTED FOR IN-GROUND BARRIERS. IT IS THE CONTRACTOR'S RESPONSIBILITY TO ENSURE THAT PERIMETER OF FENCING REMAINS AT THE DRIP-LINE OF THE TREE AND THAT TREES ARE PROTECTED.

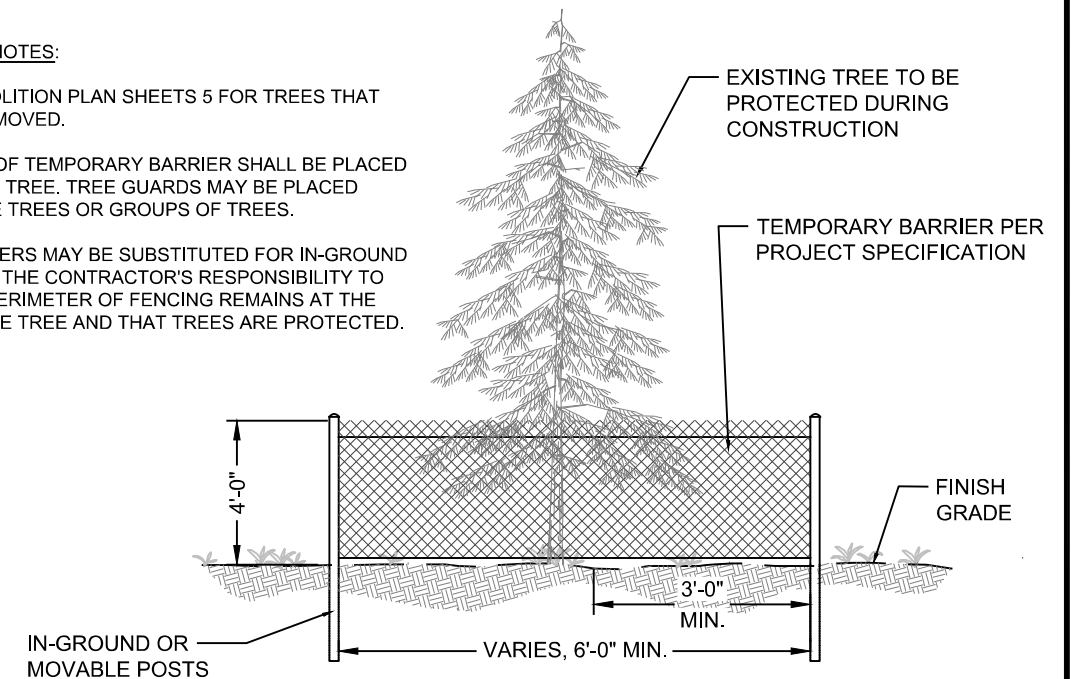

F TREE PROTECTION DETAIL
10 NTS



Emily Gillespie
07.01.2025

| REVISION | DATE | DESCRIPTION |
|----------|------------|----------------------|
| 1 | 07.01.2025 | ISSUED FOR PERMIT |
| 2 | 07.01.2025 | REVISED FOR COMMENTS |
| 3 | 07.01.2025 | REVISED FOR COMMENTS |
| 4 | 07.01.2025 | REVISED FOR COMMENTS |
| 5 | 07.01.2025 | REVISED FOR COMMENTS |

| | | | |
|----------|----|-----------|------------|
| DESIGNER | KD | PROJ. NO. | 7603 |
| DRAWN | KD | DATE | 06.12.2025 |
| CHECKED | EG | SURVEYED | DJ&A P.C. |

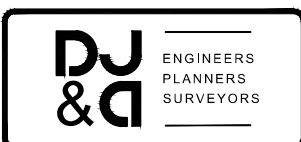

DUNCAN DRIVE TRAILHEAD
MISSOULA, MONTANA

GENERAL CIVIL DETAILS

| SHEET | OF |
|-------|----|
| 10 | 12 |

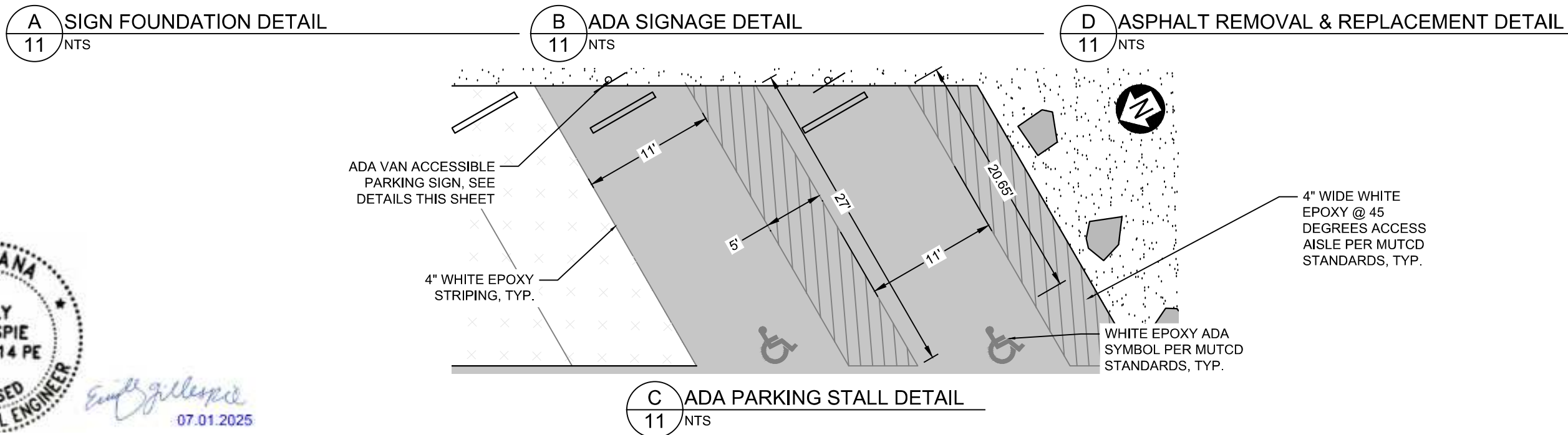
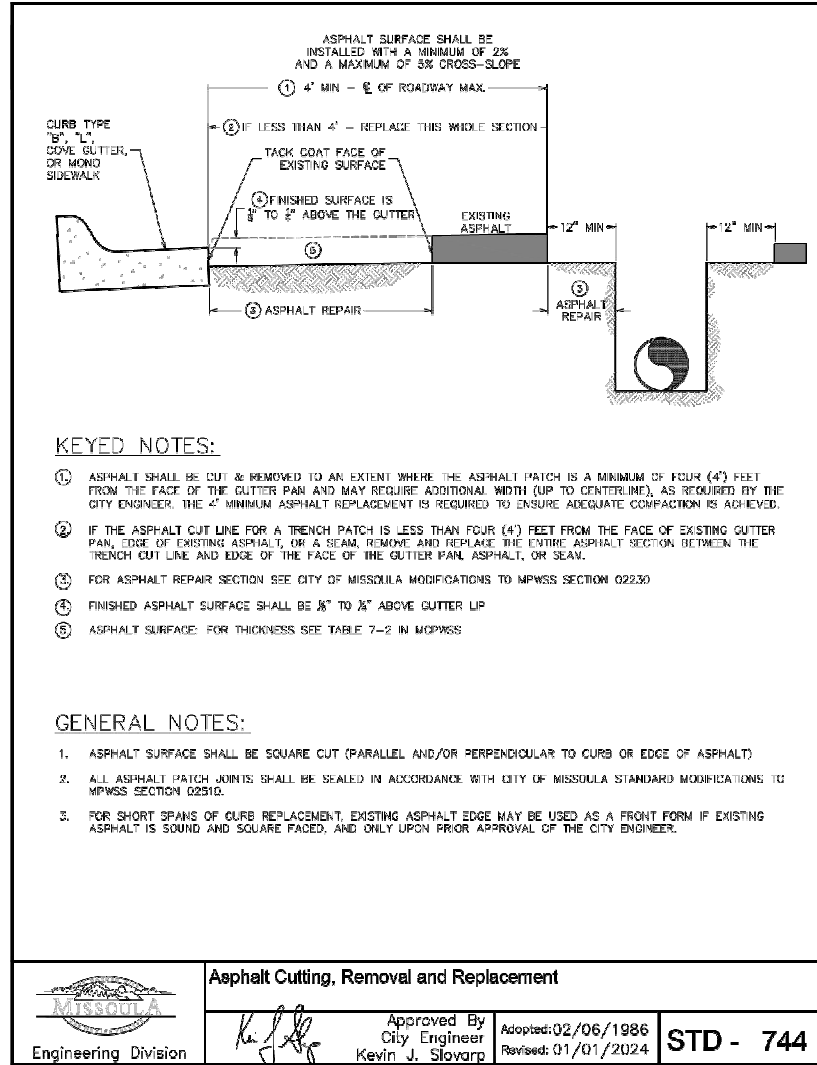
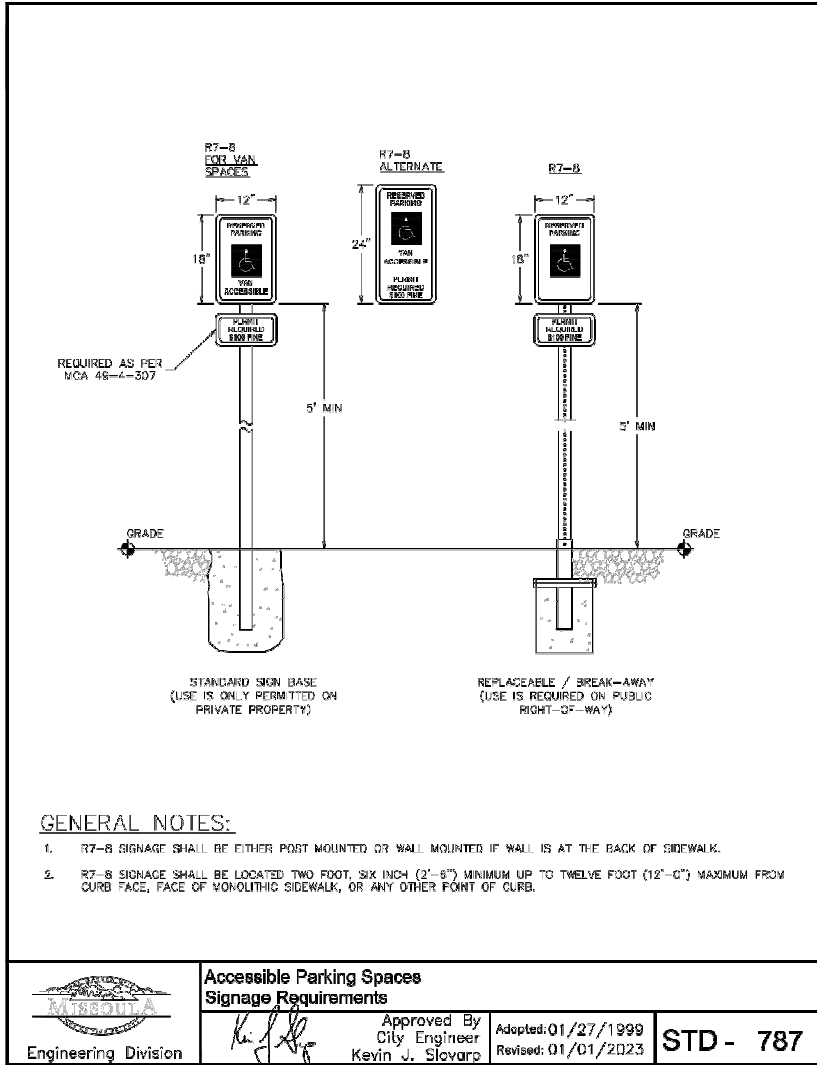
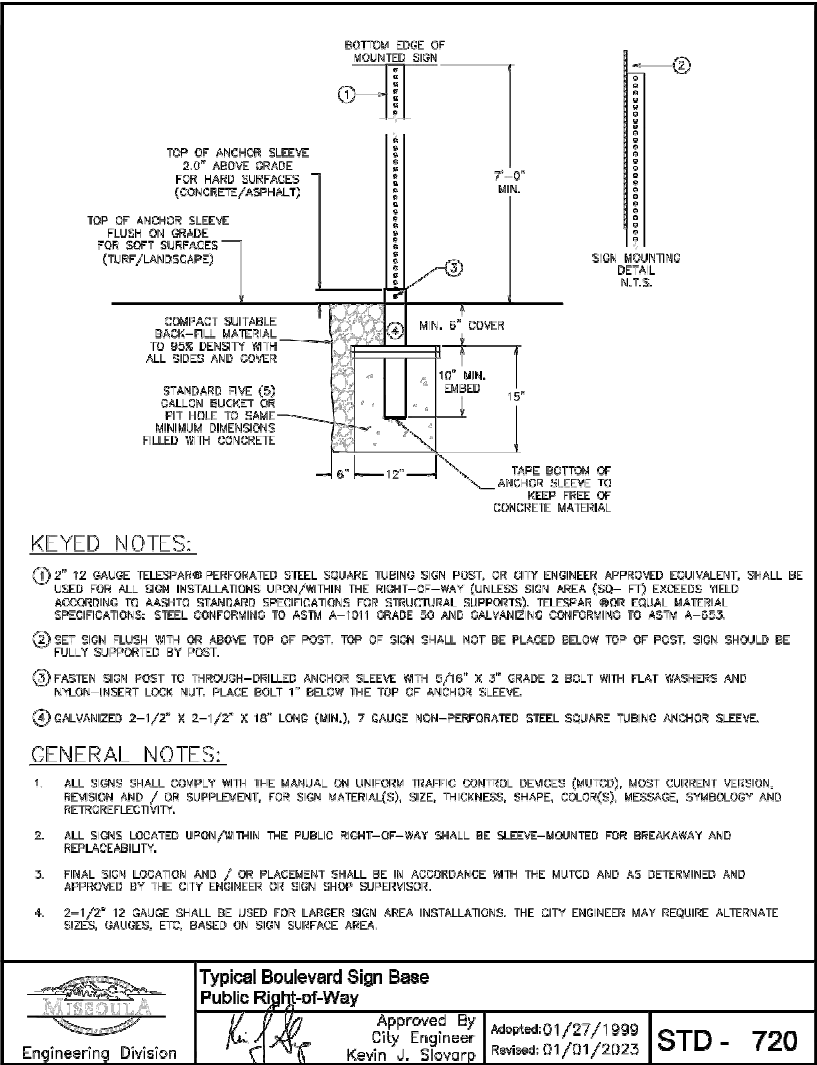

Emily Gillespie
07.01.2025

| REVISION | DATE | DESCRIPTION |
|----------|------|-------------|
| - | - | - |
| - | - | - |
| - | - | - |
| - | - | - |
| - | - | - |

| | | | |
|----------|----|-----------|------------|
| DESIGNER | KD | PROJ. NO. | 7603 |
| DRAWN | KD | DATE | 06.12.2025 |
| CHECKED | EG | SURVEYED | DJ&A P.C. |

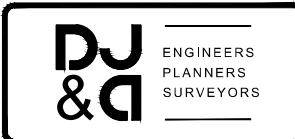

DUNCAN DRIVE TRAILHEAD
MISSOULA, MONTANA

DETAILS

| SHEET OF |
|-------------|
| 11 12 |

VEHICLE TRACKING NOTES

- 1. A FULL SIZED F150 TRUCK HAS BEEN MODELED THROUGH THE SITE USING TURN ANALYSIS TECHNOLOGY.
- 2. THE VEHICLE TRACK IS MEANT TO BE PLOTTED IN COLOR IN ORDER FOR THE READER TO DECIPHER BETWEEN LINES.
- 3. GREEN INDICATES THE PATH OF TRAVEL FOR THE FRONT BUMPER.
- 4. RED INDICATES THE PATH OF TRAVEL FOR THE WHEELS.
- 5. VEHICLE TRACKING PROVIDED FOR INFORMATIONAL PURPOSES ONLY TO THE OWNER, NO CONTRACTOR WORK IS ASSOCIATED WITH THIS SHEET.

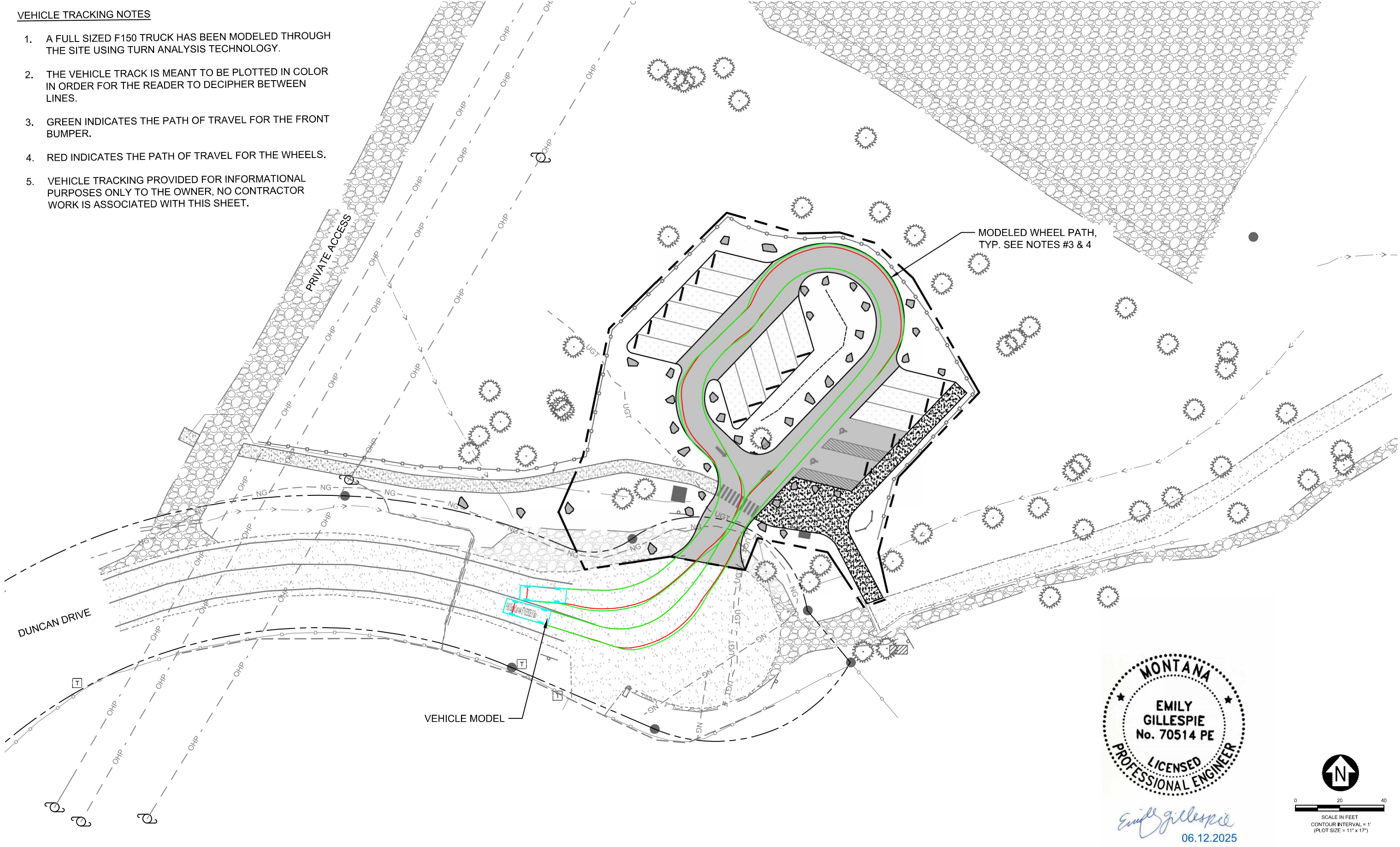

Emily Gillespie
06.12.2025



0 20 40
SCALE IN FEET
CONTOUR INTERVAL = 1'
(PLOT SIZE = 11" x 17")

| REVISION | DATE | DESCRIPTION |
|----------|------|-------------|
| - | - | - |
| - | - | - |
| - | - | - |
| - | - | - |
| - | - | - |

| | | | |
|----------|----|-----------|------------|
| DESIGNER | KD | PROJ. NO. | 7603 |
| DRAWN | KD | DATE | 06.12.2025 |
| CHECKED | EG | SURVEYED | D&A P.C. |

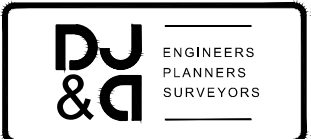

DUNCAN DRIVE TRAILHEAD
MISSOULA, MONTANA

NO CONTRACTOR WORK REQUIRED THIS SHEET
VEHICLE TRACKING

| | |
|-------|----|
| SHEET | OF |
| 12 | 12 |