

PARKING TOTALS

ON-SITE PARKING	=	272 SPACES
ON-STREET PARKING	=	47 SPACES
TOTAL	=	319

PEDESTRIAN MOBILITY ROUTE TOTALS:

LINEAR FEET OF ON-SITE SIDEWALK	=	6203'
LINEAR FEET OF ON-SITE TRAILS	=	1123'
TOTAL	=	7326'

LEGEND

- PEDESTRIAN CIRCULATION
- SIDEWALK
- PARK AREA
- COMMON AREA
- NORTH-SOUTH TRAIL EASEMENT
- EAST-WEST TRAIL EASEMENT
- TRAIL

AREA TOTALS

TOTAL SITE AREA =	1,116,317 SF	PROVIDED	REQUIRED
NET SITE AREA (TOTAL SITE - 25%+ SLOPES) =	991,429 SF		
11% PARKLAND OF 991,429 SQ FT =	116,749 SF	109,057 SF	
PARK AREAS (<5% SLOPES) =	38,575 SF		
NORTH-SOUTH TRAIL EASEMENT =	38,616 SF		
EAST-WEST TRAIL EASEMENT =	39,558 SF		
TOTAL LOTTED AREA =	476,941 SF		
TOTAL ROAD AREA =	130,501 SF		
TOTAL COMMON AREA =	508,875 SF		

~0.4 MILES TO RUSSELL ELEMENTARY SCHOOL
 BUS STOP AND MOUNTAIN LINE BUS STOP
 ~0.6 MILES TO MEADOW HILL MIDDLE SCHOOL

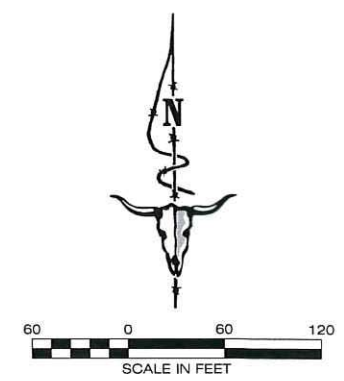
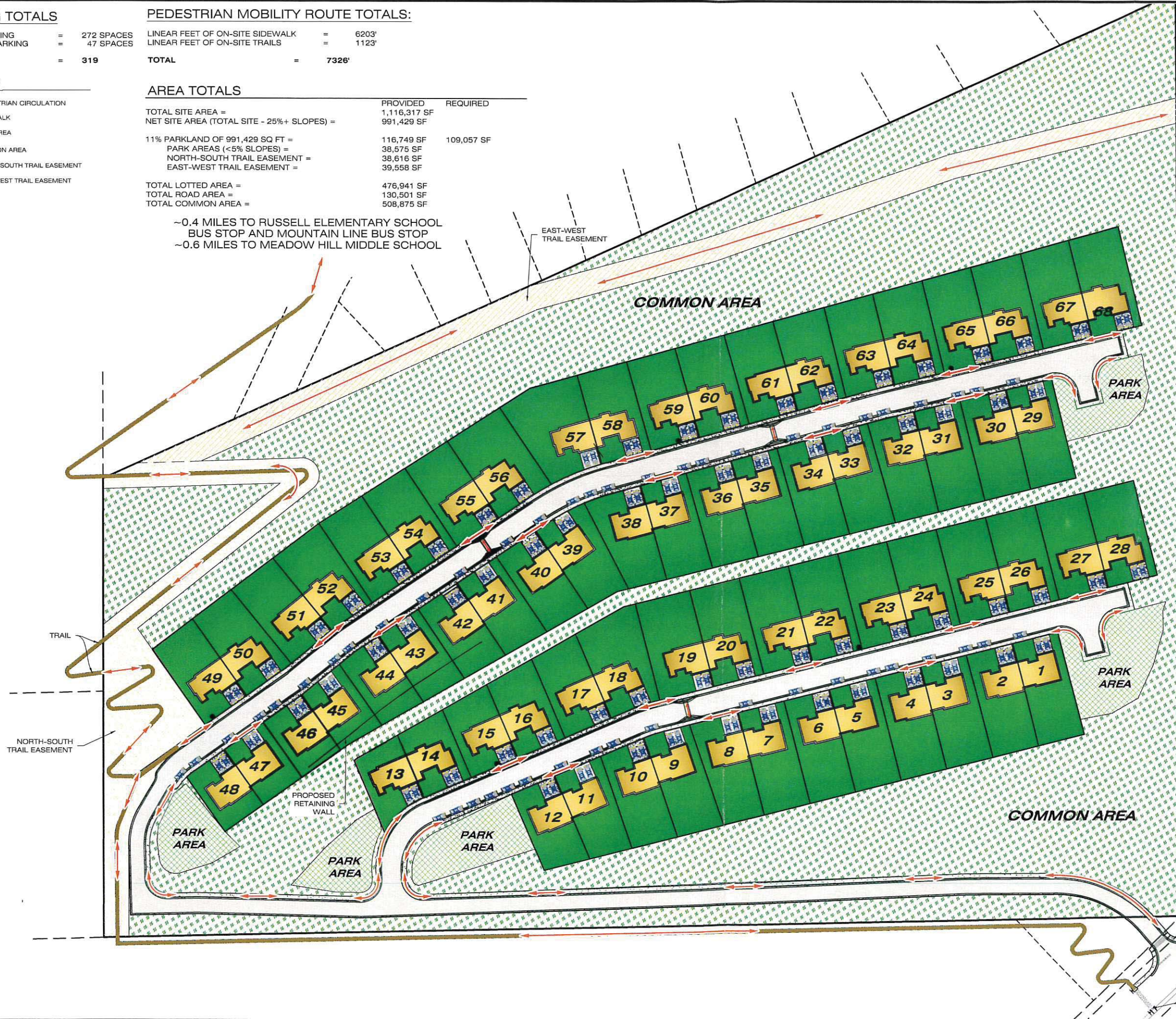

TERRITORIAL LANDWORKS, INC.
 CIVIL ENGINEERING • SURVEYING • LAND USE CONSULTING
 www.territoriallandworks.com
 P.O. Box 3851
 Missoula, MT 59806
 PHONE: 406/721-0142
 FAX: 406/721-5224
 PLOT DATE: 01/12/2018 4:02 PM

REVISIONS	DATE

DESIGNED: _____
 DRAFTED: 00
 CHECKED: _____
 DATE: 6-11-18

LOCATION: CITY OF MISSOULA
 SEC. 6, T12N, R19W, P.M.M.
 MISSOULA COUNTY
 MONTANA
 PREPARED FOR: HILLVIEW CROSSING, LLC.

PROJECT NAME: HILLVIEW CROSSING - MISSOULA
 SHEET TITLE: PARKING AND PEDESTRIAN CIRCULATION EXHIBIT

PROJECT NO. 14-3592
 SHEET: 1 OF 1

~1 MILE TO RUSSELL ELEMENTARY SCHOOL
 ~0.7 MILES TO SENTINEL HIGH SCHOOL BUS
 STOP AND MOUNTAIN LINE BUS STOP
 ~0.8 MILES TO GROCERY SERVICES

CROSSWALK W/ CROSSING
 BEACON AND RRFB
 BI-DIRECTIONAL FLASHER

DRAWN LOCATION: 11/12/2017 11:11:11 AM PROJECT: 14-3592 - HILLVIEW CROSSING - MISSOULA 5 HILLS DEVELOPMENT, DRAFTING: JAL, DRAWING: AUTOCAD/PLT
 SETS/DRAWING COMPLIANCE/PAVING SPH: 14-3592.DWG