











-  TYPE III BARRICADE
-  TYPE II BARRICADE
-  TYPE I BARRICADES

-  WARNING SIGNS
-  DETOUR SIGNS
-  DETOUR ROUTING
-  REGULATORY SIGNS

-  DELINEATORS
-  SIGN LOCATION SYMBOL
-  WORK ZONE

 SIDEWALK CLOSED
MUST BE USED
WHENEVER A CITY
SIDEWALK IS TO BE
CLOSED

TRAFFIC CONTROL MUST CONFORM TO THE MANUAL ON UNIFORM TRAFFIC CONTROL DEVICES (MUTCO)

SPACING AND TAPER LENGTHS
CALCULATED FOR 35 MPH
HIGHER SPEEDS MAY REQUIRE
CHANGED DISTANCES AND
ADDITIONAL SIGNING

REQUIREMENTS FOR A
COLLECTOR AND
ARTERIAL CROSS
STREET IN ()

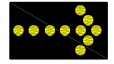
MAY BE REQUIRED
FOR HIGHER
SPEEDS AND
VOLUMES

TRAFFIC CONTROL MINIMUM REQUIREMENTS
SHALL INCLUDE PROVIDING FOR THE NEEDS AND
CONTROL OF ALL USERS; MOTORISTS, BICYCLISTS
AND PEDESTRIANS, INCLUDING PERSONS WITH
DISABILITIES IN ACCORDANCE WITH THE
AMERICANS WITH DISABILITIES ACT (ADA),
THROUGH A TEMPORARY TRAFFIC CONTROL ZONE
SHALL BE ESSENTIAL IN ANY ROADWAY
CONSTRUCTION, UTILITY WORK, MAINTENANCE
OPERATIONS AND THE MANAGEMENT OF TRAFFIC
INCIDENTS. SPECIAL ATTENTION SHALL BE USED
WHEN / WHERE TEMPORARY TRAFFIC CONTROL
IS ADJACENT TO PUBLIC SCHOOLS AND DURING
PERIODS OF PEAK-HOUR TRAFFIC.

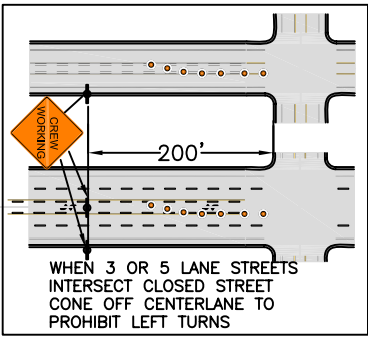
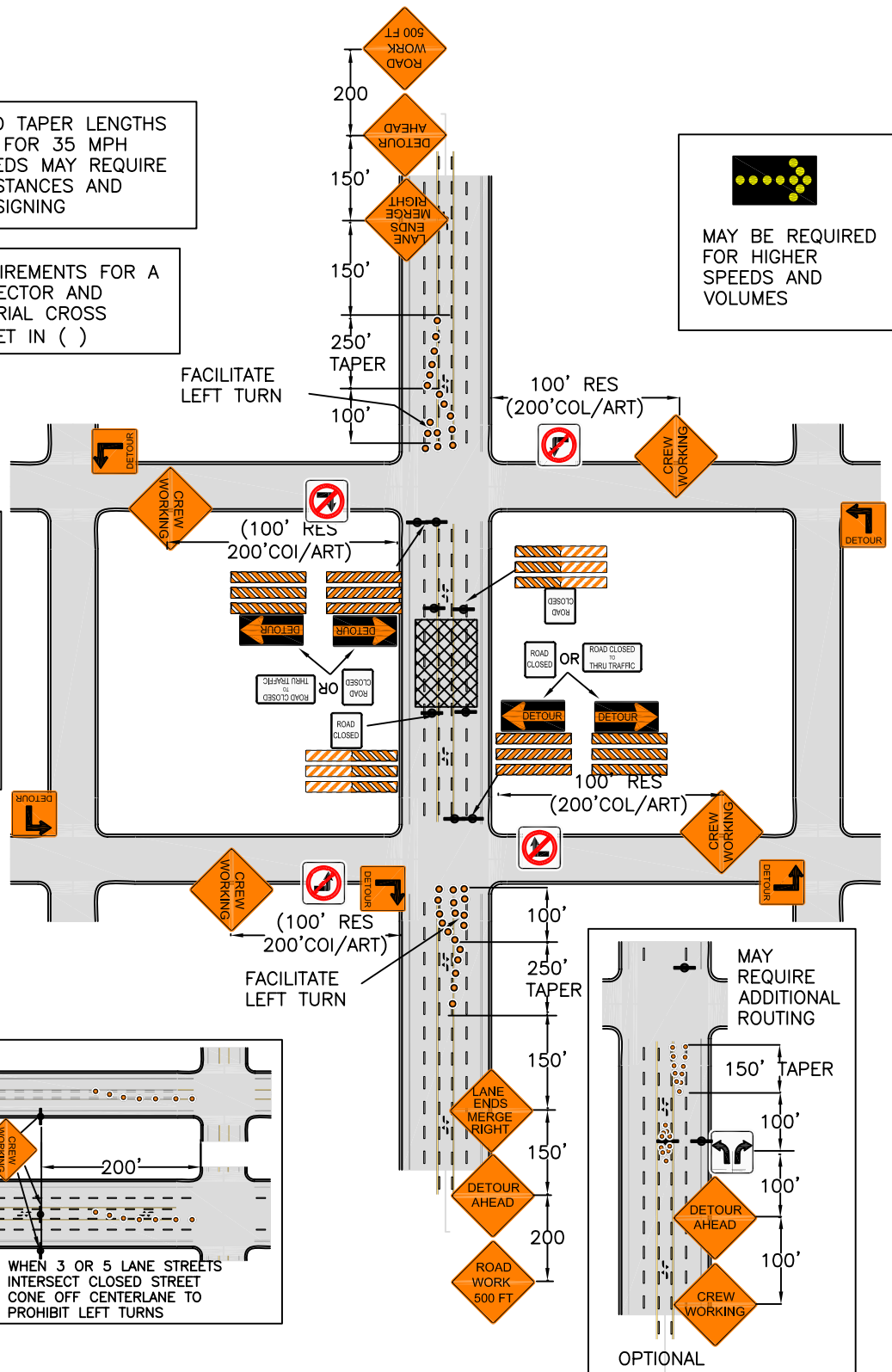

Digital Standard Drawings and other maps are available on the City website: http://www.ci.missoula.mt.us/publicworks/gis_maps.htm



TYPICAL TRAFFIC CONTROL PLAN

STREET CLASSIFICATION:
5 LANE ARTERIAL
CLOSE STREET

Revision Date:
03/2004
TC - 507