

## ELEVATION CERTIFICATE

Important: Follow the instructions on pages 1-9.

Copy all pages of this Elevation Certificate and all attachments for (1) community official, (2) insurance agent/company, and (3) building owner.

SECTION A - PROPERTY INFORMATION				FOR INSURANCE COMPANY USE	
A1. Building Owner's Name William Stanley Sneath and Ann McCloud Sneath				Policy Number:	
A2. Building Street Address (including Apt., Unit, Suite, and/or Bldg. No.) or P.O. Route and Box No. 900 Lolo Street				Company NAIC Number:	
City Missoula		State Montana		ZIP Code 59802	
A3. Property Description (Lot and Block Numbers, Tax Parcel Number, Legal Description, etc.) Book 969 (Micro) Page 3, Records of Missoula County; Geocode 04-2200-14-2-15-18-0000; in Sec. 14, T.13N., R.19W.					
A4. Building Use (e.g., Residential, Non-Residential, Addition, Accessory, etc.) <u>Addition (Residential)</u>					
A5. Latitude/Longitude: Lat. <u>N46.88492°</u> Long. <u>W113.97059°</u> Horizontal Datum: <input type="checkbox"/> NAD 1927 <input checked="" type="checkbox"/> NAD 1983					
A6. Attach at least 2 photographs of the building if the Certificate is being used to obtain flood insurance.					
A7. Building Diagram Number <u>4</u>					
A8. For a building with a crawlspace or enclosure(s):					
a) Square footage of crawlspace or enclosure(s) <u>1,644</u> sq ft					
b) Number of permanent flood openings in the crawlspace or enclosure(s) within 1.0 foot above adjacent grade <u>0</u>					
c) Total net area of flood openings in A8.b <u>0</u> sq in					
d) Engineered flood openings? <input type="checkbox"/> Yes <input type="checkbox"/> No					
A9. For a building with an attached garage:					
a) Square footage of attached garage <u>0</u> sq ft					
b) Number of permanent flood openings in the attached garage within 1.0 foot above adjacent grade <u>0</u>					
c) Total net area of flood openings in A9.b <u>0</u> sq in					
d) Engineered flood openings? <input type="checkbox"/> Yes <input type="checkbox"/> No					
SECTION B - FLOOD INSURANCE RATE MAP (FIRM) INFORMATION					
B1. NFIP Community Name & Community Number City of Missoula 300049			B2. County Name Missoula		B3. State Montana
B4. Map/Panel Number 300063C1215E	B5. Suffix E	B6. FIRM Index Date 08/16/1988	B7. FIRM Panel Effective/ Revised Date 07/06/2015	B8. Flood Zone(s) AO	B9. Base Flood Elevation(s) (Zone AO, use Base Flood Depth) 1'
B10. Indicate the source of the Base Flood Elevation (BFE) data or base flood depth entered in Item B9: <input type="checkbox"/> FIS Profile <input checked="" type="checkbox"/> FIRM <input type="checkbox"/> Community Determined <input type="checkbox"/> Other/Source: _____					
B11. Indicate elevation datum used for BFE in Item B9: <input type="checkbox"/> NGVD 1929 <input checked="" type="checkbox"/> NAVD 1988 <input type="checkbox"/> Other/Source: _____					
B12. Is the building located in a Coastal Barrier Resources System (CBRS) area or Otherwise Protected Area (OPA)? <input type="checkbox"/> Yes <input checked="" type="checkbox"/> No Designation Date: _____ <input type="checkbox"/> CBRS <input type="checkbox"/> OPA					

**ELEVATION CERTIFICATE**OMB No. 1660-0008  
Expiration Date: November 30, 2018

<b>IMPORTANT: In these spaces, copy the corresponding information from Section A.</b>			<b>FOR INSURANCE COMPANY USE</b>
Building Street Address (including Apt., Unit, Suite, and/or Bldg. No.) or P.O. Route and Box No. 900 Lolo Street			Policy Number:
City Missoula	State Montana	ZIP Code 59802	Company NAIC Number

**SECTION C – BUILDING ELEVATION INFORMATION (SURVEY REQUIRED)**C1. Building elevations are based on: ☒ Construction Drawings\* ☐ Building Under Construction\* ☐ Finished Construction

\*A new Elevation Certificate will be required when construction of the building is complete.

C2. Elevations – Zones A1–A30, AE, AH, A (with BFE), VE, V1–V30, V (with BFE), AR, AR/A, AR/AE, AR/A1–A30, AR/AH, AR/AO. Complete Items C2.a–h below according to the building diagram specified in Item A7. In Puerto Rico only, enter meters.

Benchmark Utilized: MSOL CORS GPS Station Vertical Datum: NAVD 1988

Indicate elevation datum used for the elevations in items a) through h) below.

☐ NGVD 1929 ☒ NAVD 1988 ☐ Other/Source: \_\_\_\_\_

Datum used for building elevations must be the same as that used for the BFE.

Check the measurement used.

- |   |               |  |
|---|---------------|--|
| a) Top of bottom floor (including basement, crawlspace, or enclosure floor)   | <u>3296.1</u> | <input checked="" type="checkbox"/> feet <input type="checkbox"/> meters |
| b) Top of the next higher floor   | <u>3307.8</u> | <input checked="" type="checkbox"/> feet <input type="checkbox"/> meters |
| c) Bottom of the lowest horizontal structural member (V Zones only)   | _____         | <input checked="" type="checkbox"/> feet <input type="checkbox"/> meters |
| d) Attached garage (top of slab)  | _____         | <input checked="" type="checkbox"/> feet <input type="checkbox"/> meters |
| e) Lowest elevation of machinery or equipment servicing the building<br>(Describe type of equipment and location in Comments) | <u>3296.1</u> | <input checked="" type="checkbox"/> feet <input type="checkbox"/> meters |
| f) Lowest adjacent (finished) grade next to building (LAG)  | <u>3304.1</u> | <input checked="" type="checkbox"/> feet <input type="checkbox"/> meters |
| g) Highest adjacent (finished) grade next to building (HAG)   | <u>3304.8</u> | <input checked="" type="checkbox"/> feet <input type="checkbox"/> meters |
| h) Lowest adjacent grade at lowest elevation of deck or stairs, including structural support                                  | <u>3304.3</u> | <input checked="" type="checkbox"/> feet <input type="checkbox"/> meters |

**SECTION D – SURVEYOR, ENGINEER, OR ARCHITECT CERTIFICATION**

This certification is to be signed and sealed by a land surveyor, engineer, or architect authorized by law to certify elevation information. I certify that the information on this Certificate represents my best efforts to interpret the data available. I understand that any false statement may be punishable by fine or imprisonment under 18 U.S. Code, Section 1001.

Were latitude and longitude in Section A provided by a licensed land surveyor? ☒ Yes ☐ No ☐ Check here if attachments.

Certifier's Name Matthew Jacobson	License Number 13748LS
Title Lead Surveyor (Professional Land Surveyor)	
Company Name Territorial-Landworks, Inc.	
Address PO Box 3851	
City Missoula	State Montana
ZIP Code 59806	
Signature 	Date 5/7/19
Telephone (406) 721-0142	

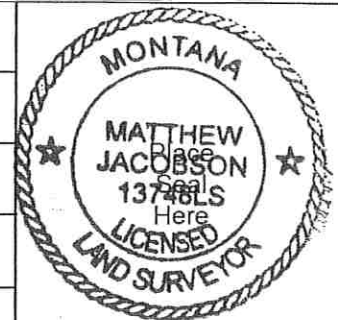

Copy all pages of this Elevation Certificate and all attachments for (1) community official, (2) insurance agent/company, and (3) building owner.

Comments (including type of equipment and location, per C2(e), if applicable)

Recessed 'mechanical room' in existing enclosure contains furnace and hot water heater; assuming this will service addition.

Square footage per item A8(a) includes existing building footprint and proposed addition area as marked on the ground by others.

Elevation listed per item C2(a) is as-measured on the existing building footprint, to which the proposed addition will be attached.

Elevation listed per item C2(b) is designed 3.0' above the HAG for the proposed addition. Existing building floor is at 3306.9'.