



Missoula County Vickie M Zeier NOT

200508286

Page: 1 of 5

04/12/2005 04:00P

Bk-750 Pg-919

After recording return to:  
Carolynn M. Fagan  
Sullivan, Tabaracci & Rhoades, PC  
1821 South Ave. West  
Missoula, MT 59801  
(406) 721-9700

#### **NOTICE OF AIRPORT INFLUENCE AREA BOUNDARIES**

WHEREAS, pursuant to Montana Code Annotated § 67-4-201, Missoula County created an Airport Influence Area by Resolution No. 78-96 (Book 121 Micro Records, Page 1391), 78-187 (Book 135 Micro Records, Page 474) and 87-021 (Book 255 Micro Records, Page 2383);

WHEREAS, the above referenced Resolutions provide criteria and guidelines to control noise sensitive land uses and the height of structures and trees within the airport influence area;

WHEREAS, Missoula International Airport is operated by the Missoula County Airport Authority (the "Authority") pursuant to Title 67, Chapter 11, Montana Code Annotated; and

WHEREAS, the AUTHORITY desires to give notice to the public and those owning or purchasing real property within the Airport Influence Area of the provisions of the above-referenced Resolutions;

NOW, THEREFORE, the Authority gives notice of the boundaries of the Airport Influence Area. Pursuant to Montana Code Annotated § 67-4-202, "After the designation of an airport influence area, a person may not recover from a local government, an airport authority, an airport operator, or an airport owner damages caused by noise and vibrations from normal and anticipated normal airport operations."



200508286

Page: 2 of 5  
04/12/2005 04:00P

Missoula County Vickie M Zeier NOT

Bk-750 Pg-919

Attached to this Notice, as Exhibit "A", is a legal description and map setting forth the boundaries of the Airport Influence Area.

DATED this 11 day of April, 2005.

MISSOULA COUNTY AIRPORT AUTHORITY

By: [Signature]  
Joe Easton  
Acting Director

State of Montana     )  
                                  ) ss.  
County of Missoula    )

This instrument was acknowledged before me by Joe Easton, on behalf of the Missoula County Airport Authority, this 11 day of April, 2004.



Catherine L. Tortorelli  
Notary Public for the State of Montana  
Printed Name: CATHERINE L. TORTORELLI  
Residing at: MISSOULA  
My commission expires: 5-6-2007

EXHIBIT "A"

MISSOULA INTERNATIONAL AIRPORT INFLUENCE AREA

LEGAL DESCRIPTION

A tract of land located in Sections 6, 7, 8 and 18, Township 13 North, Range 19 West, Sections 1, 2, 3, 4, 10, 11, 12, 13 and 14, Township 13 North, Range 20 West, Sections 21, 22, 26, 27, 28, 32, 33, 34, 35 and 36, Township 14 North, Range 20 West, Principal Meridian Montana, Missoula County Montana, being that land area described in Missoula County Commissioners Resolution No. 78-96 and being further described as:

Commencing at the section corner common to Sections 1 and 2, Township 13 North, Range 20 West and Sections 35 and 36, Township 14 North, Range 20 West, Principal Meridian Montana, thence S58°30'33"E, 14146.35 feet to the most easterly corner of the Airport Influence Area, the true point of beginning, the section corner common to Sections 5, 6, 7 and 8, Township 13 North, Range 19 West bears approximately N35°03'31"W, 2583.58 feet; thence S40°27'54"W, 10560.00 feet to the most southerly corner of the Airport Influence Area, the southeast corner of Section 13, Township 13 North, Range 20 West bears approximately S09°25'14"E, 529.13 feet; thence N49°32'06"W, 29499.71 feet to the most westerly corner of the Airport Influence Area, the southeast corner of Section 32, Township 14 North, Range 20 West bears approximately S19°49'31"E, 3967.17 feet; thence N40°27'54"E, 10560.00 feet to the most northerly corner of the Airport Influence Area; thence S49°32'06"E, 29499.71 feet to the point of beginning. Containing 7,151 acres more or less and being subject to all easements, dedications or reservations shown, existing or of record.

SURVEYORS STATEMENT

This exhibit "A" is a correct representation and depiction of Missoula International Airport influence area as prepared by me or under my direct supervision. This exhibit represents the size and dimensions of the airport influence area as adopted under Missoula County resolution no. 78-96 on July 5, 1978 and amended December 6, 1978. The dimensions are referenced under section 1.05 (definitions), line item 9. (airport influence area) and also referenced under chapter II (airport land use districts) section 2.01 (purposes).

BY:

Glenn R. Howard  
GLENN R. HOWARD, P.L.S.

2/16/05  
DATE

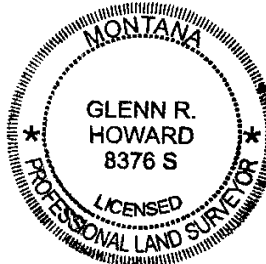

# EXHIB

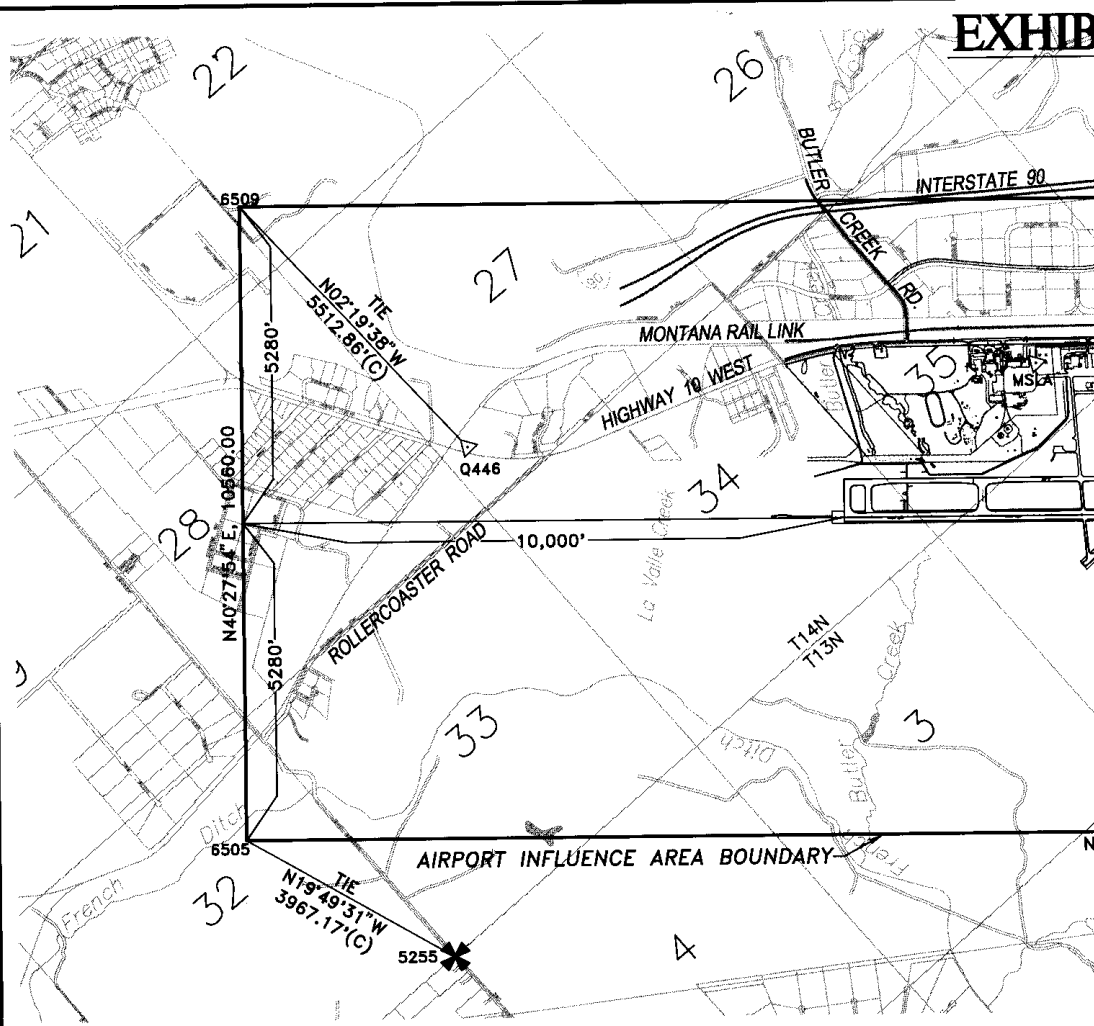

NAME	GEODEIC COORDINATES		MT STATE PLANE NAD83(1999)		LOCAL COORDINATES		DESC
	LATITUDE	LONGITUDE	NORTHING	EASTING	NORTHING	EASTING	
6500	46°54'04.1423"N	114°02'00.8298"W	304583.088	254965.986	1000096.65	837033.89	CALCULATE
6504	46°52'44.8920"N	114°03'39.3499"W	302262.614	252738.962	992062.58	830180.62	CALCULATE
6505	46°55'53.7855"N	114°09'02.5827"W	308483.879	246256.643	1011207.41	807737.17	CALCULATE
6509	46°57'13.1127"N	114°07'23.8988"W	310804.353	246483.667	1019241.49	814590.44	CALCULATE
5120	46°54'25.0235"N	114°02'21.9777"W	305252.566	254552.494	1002211.48	835549.84	2 1/4" BI
5147	46°52'39.7404"N	114°03'38.1057"W	302102.358	252755.983	991540.58	830287.22	1 1/2" BI
5255	46°55'16.9650"N	114°08'43.1598"W	307325.174	246599.169	1007475.40	809082.89	2 1/4" BI
5426	46°55'17.1182"N	114°04'54.3060"W	307045.029	251430.125	1007486.18	824970.97	2 1/2" BI
5609	46°53'08.2298"N	114°02'47.5409"W	302917.927	253875.238	994429.00	833778.96	5/8" REB
MSLA	46°55'27.8666"N	114°05'24.6453"W	307413.711	250809.135	-1008575.19	822864.65	3 1/4" BI
Q446	46°56'18.7534"N	114°07'20.6391"W	309125.579	248453.472	1013733.17	814814.31	STAINLESS
R002	46°54'22.9605"N	114°03'11.3618"W	305249.598	253508.055	1002000.52	832120.50	2 1/2" AI

NOTE: THE LOCAL NORTH AND EAST COORDINATES ARE GROUND COORDINATES ON A TRUE BEARING, DERIVED FROM MOI PLANE COORDINATES (METER) "USING A COMBINED SCALE FACTOR OF .999241 X 3.280839895 (METER TO GROUND SI GRID BEARING ROTATION OF -3°21'27.8" AT POINT MSLA".

BY	DATE	REVISION DESCRIPTION	DESIGN	PROJ. NO.	4627
			DRAWN	DATE	2/2005
			CHECKED		

3201 Russell Blvd., Kansas, Missouri 64111-0001  
Phone (816) 731-1000 Fax (816) 731-1001

200508286  
Page: 4 of 5  
04/12/2005 04:30P  
Missoula County Vickie H Zeier NOT  
Bk-750 Pg-919

F:\4927.dwg\SURVEY-SI FEET.dwg, 2/16/2005 10:26:36 AM

F "A"

36

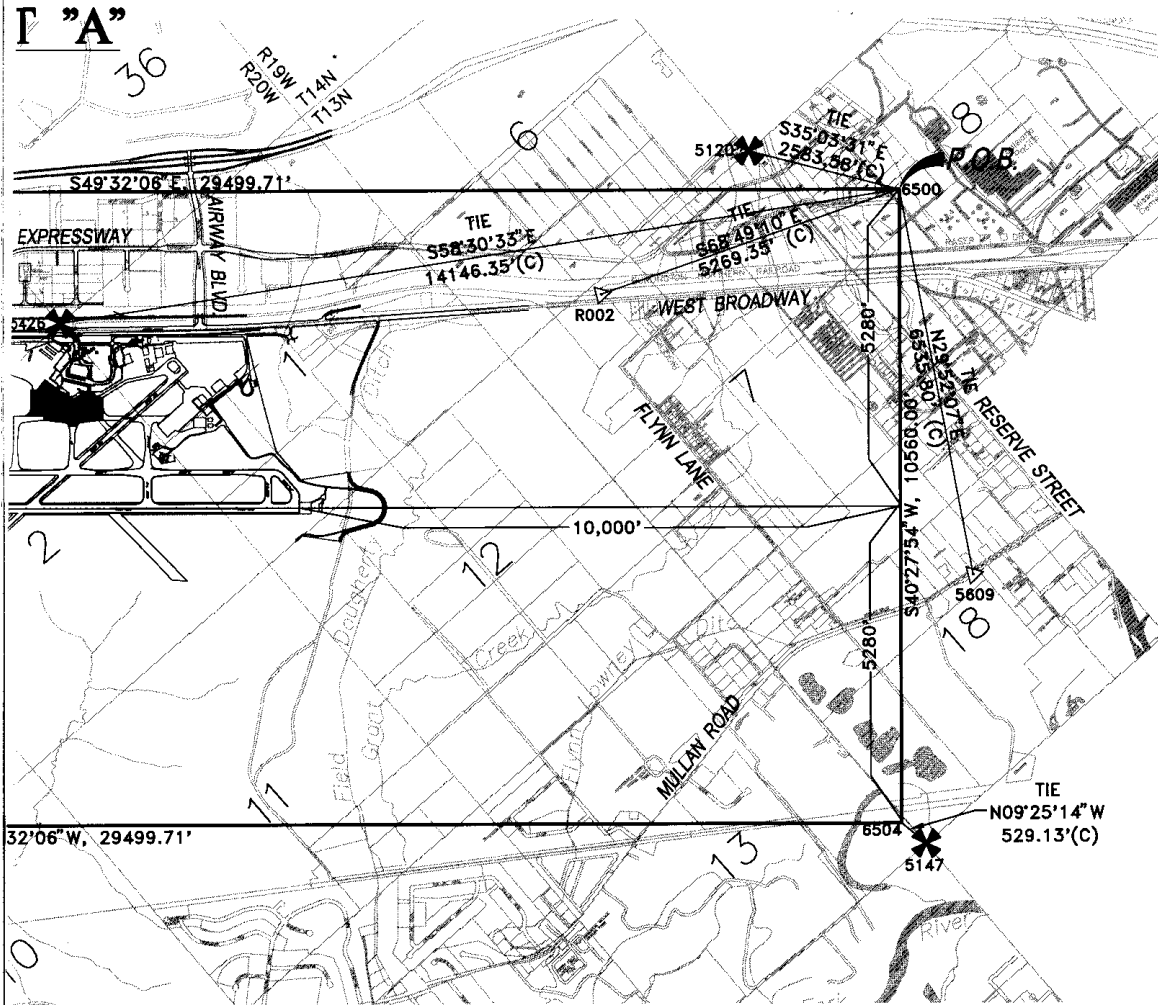

ION
OSITION
OSITION
OSITION
S CAP
S CAP
S CAP
S CAP
PUNCH MARK
S CAP
EEL ROD
NUM CAP

**LEGEND**



SECTION CORNER



EXISTING MONUMENT (REFER TO MISSOULA COUNTY SURVEYORS OFFICE FOR MONUMENT LOCATION DESCRIPTION)

(C) COMPUTED

**NOTES**

1) THIS EXHIBIT REPRESENTS A GRAPHICAL LOCATION OF THE AIRPORT INFLUENCE AREA, IN RELATION TO THE MISSOULA COUNTY GIS BASE MAPS, AND WAS DEVELOPED USING EXISTING SURVEY AND MAPPING RECORDS.

2) SECTION CORNERS AND MONUMENT TIES ARE BASED ON A COMBINATION OF DJ&A, P.C. FIELD SURVEYS AND CALCULATIONS USING THE MISSOULA COUNTY SURVEYORS OFFICE STATE PLANE COORDINATE POSITIONS.

3) THE AIRPORT INFLUENCE AREA BOUNDARY DIMENSIONS ARE BASED ON MISSOULA COUNTY COMMISSIONERS RESOLUTION No. 78-96.

HA STATE  
(7) AND



200508286

Page: 5 of 5  
04/12/2005 04:00P  
Bk-750 Pg-919

Missoula County Vickie H Zeier NOT

PREPARED FOR :  
MISSOULA INTERNATIONAL AIRPORT  
MISSOULA, MONTANA

MISSOULA INTERNATIONAL AIRPORT  
INFLUENCE AREA

SHEET

OF

1

1